

# ABRAHAM FAMILY HOUSES

## CONCEPTUALIZATION BASED ON THE DOME OF THE TABLETS LOCATION ON TEMPLE MOUNT

The purpose of this illustration is to consider that the Abraham Family House(s) for each for the 3 Abrahamic Faiths, Judaism, Christianity and Islam will converge theologically to become the New World Religion. This supposition is based on the Biblical Narrative that in the Last Days, specifically during Daniel's Last Week, the 70th yet to be fulfilled is what will characterize the Hybrid Religion of the coming False Messiah, AntiChrist or the Mahdi. Moreover, that these 3 Structures, Temples or Houses that are being constructed presently in Abu Dhabi will eventually be replicated onto the Temple Mount. Why there? The conjecture is that what will usher-in the coming New World Order Religion that will necessitate such an undertaking to unite most, if not all of the Peoples of the world around. If there is any one piece of real estate on Earth that is most contentious, it is the Temple Mount. Why there? According to the Bible, this is the only place on Earth that the Creator, YHVH put His Name and claimed it exclusively. Realize that the Bible teaches that all the Earth, every Land and Nation belongs to YHVH.



the Abraham Family House(s) in Abu Dhabi projected to be sometime in 2022. constructed presently in Saadiyat Island .

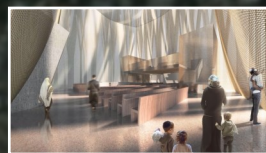

**1. SYNOGOGUE**  
Moses Ben Maimon  
Synagogue

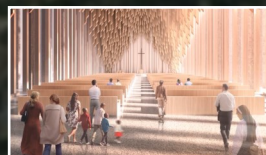

**2. CHURCH**  
Saint Francis Church

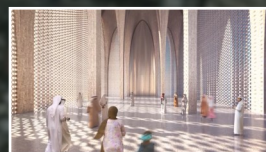

**3. MOSQUE**  
Imam Al-Tayeb Mosque

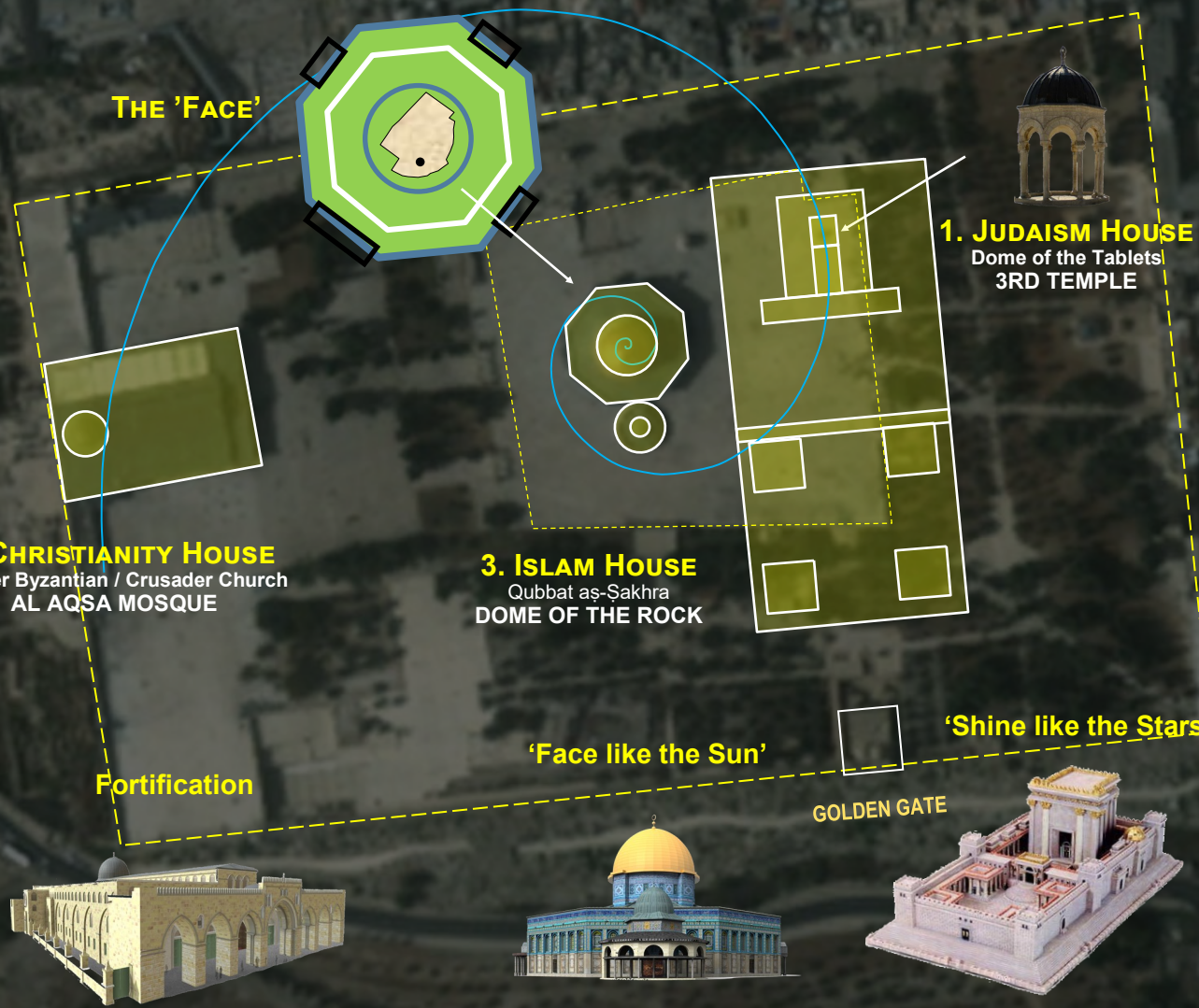

TEMPLE MOUNT IN JERUSALEM CROSS-SECTION LOOKING WEST.

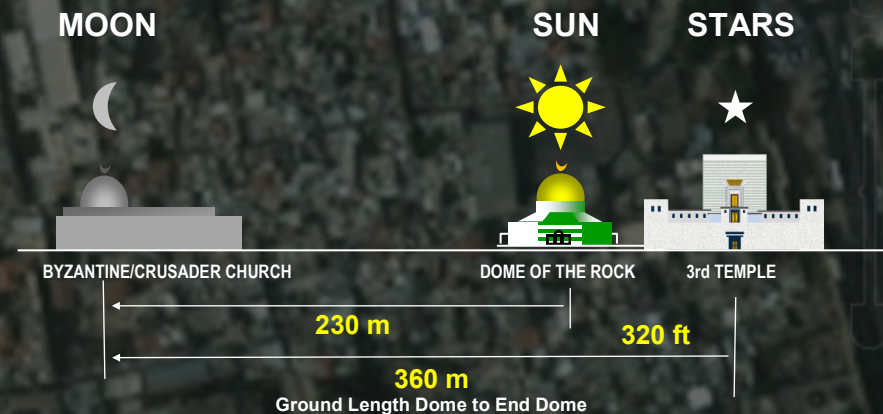

**AntiChrist in the 3rd Temple**  
Holy of Holies Mercy Seat (Throne)  
**HOLY OF HOLIES**



**ARK OF THE COVENANT**  
(Ark's design by Wyatt's eyewitness)

Sealed up to prevent Messiah from entering through Muslim Cemetery as Christ is prophesied to enter it at 2nd Advent - EZEK 43:1 / ZECH 14:2

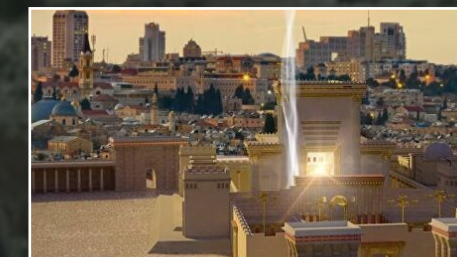

### יְרוּשָׁלַיִם TEMPLE MOUNT JERUSALEM, ISRAEL

© Composition & Some Graphics by  
**LUIS B. VEGA**  
Earth.Google.com  
vegapost@hotmail.com  
PostScripts.org

**MAIN SOURCES**  
Earth.Google.com  
TempleInstitute.org  
Wikipedia.com

The 3 Houses or Structures on the Temple Mount will be in approximate Phi Ratio to each other. The supposedly 'Abraham' Houses will have been finished or completed the eventual takeover of the most Holiest Site on Earth according to the Bible. This endeavor, seemingly a good gesture to provide 'Peace and Security' not only to the Israel, the Middle East but the World will only produce the opposite. It is a Luciferian Plot to takeover the Humanity in a Nimrod and Tower of Babel 2.0. event. It will be cause for the rise of the Luciferian Religion that will be inaugurated for the New World Order that will encompass Daniel's Last 7-Year Week of Years.