

SPECIFICATIONS:

Impedance: 50 Ohm
 Frequency: DC–18 GHz
 Operating temp. : -45°C - +85°C
 VSWR: 1.15:1 Max @ 12 GHz
 1.20:1 Max. @ 18 GHz
 Power: 1 Watt
RoHS Compliant

Part	Material	Plating
Body	Stainless Steel	Passivated
Coupling Cap	Stainless Steel	Passivated
Center Contact	Brass	Gold
Insulator	PTFE	—
Gasket	Silicone Rubber	—

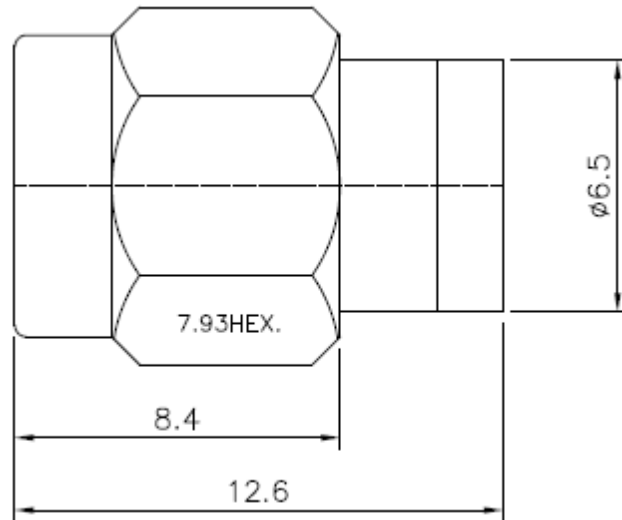

Dimensions are in mm,
 for reference only, and are
 subject to change
 without notice.



Premier RF
 17 Roslyn CT
 Patchogue, NY 11772
 PH: 631-447-3804
 sales@premierf.com
 www.premierf.com

8/23/2013
 APPROVED
 A. Ianacci

PART NUMBER	PRF-TE1M118-SP
DESCRIPTION	SMA MALE TERMINATION DC-18 GHz, 1 WATT