

# DOLLAR GENERAL STORE INNSBROOK, MISSOURI

PARKING SPACES/REQD: 35 / 53  
 BLDG/SALES SF: 10,640 / 8,504  
 ENGINEER: OVERLAND ENGINEERING, LLC  
 DEVELOPER: DGOGINNSBROOKMO06152022 LLC

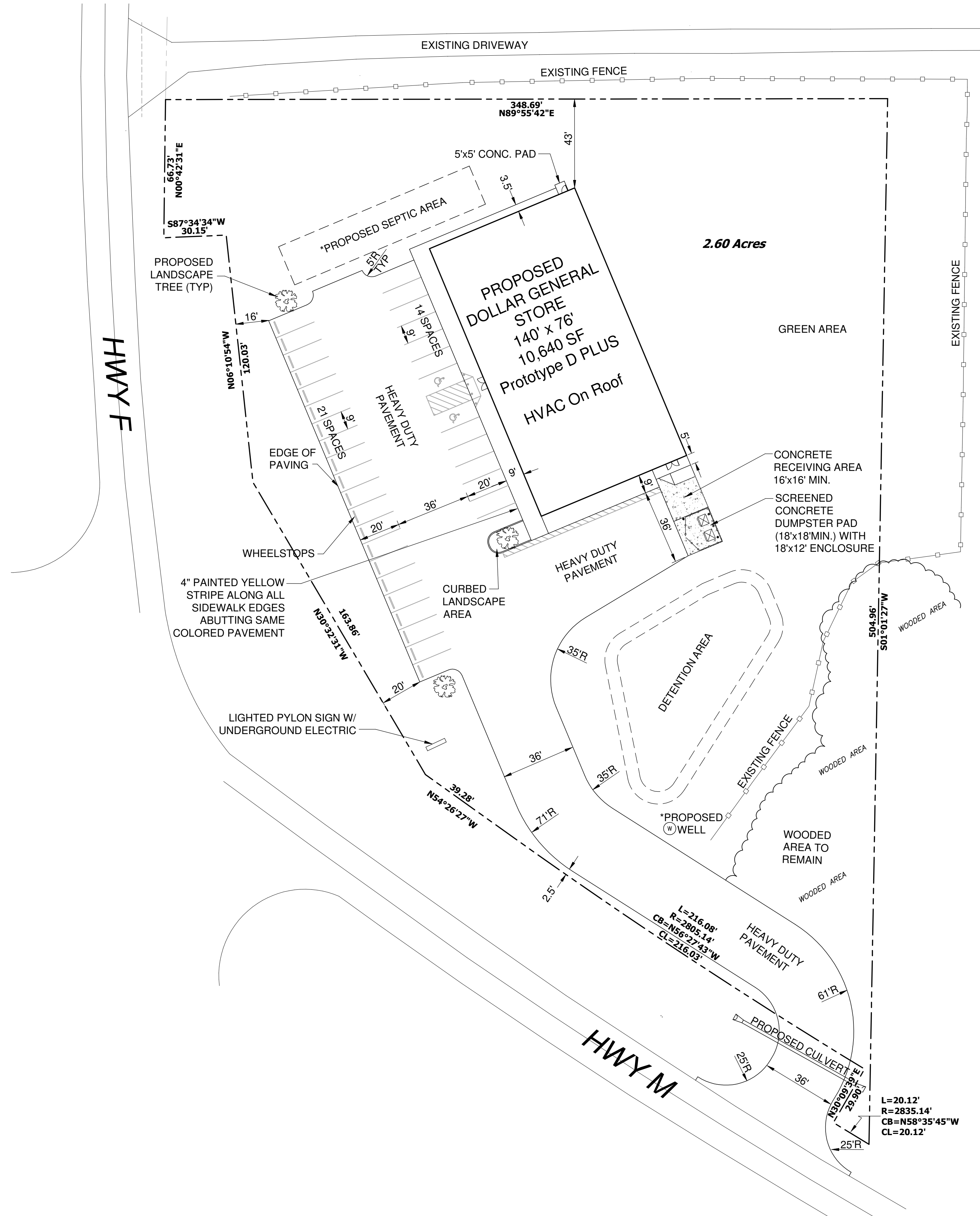
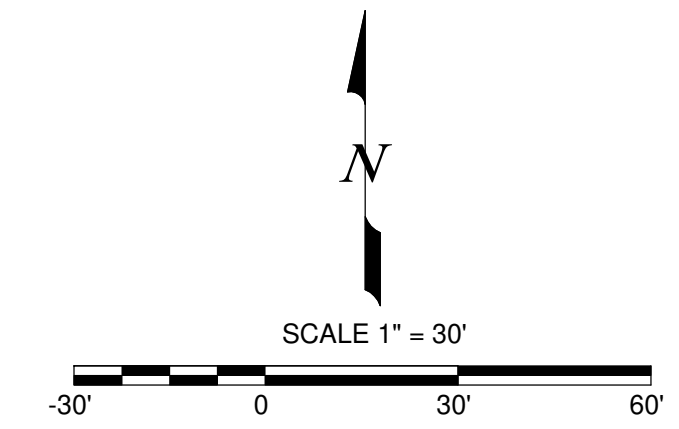

### GENERAL NOTES

1. THE CONSTRUCTION COVERED BY THESE PLANS SHALL CONFORM TO ALL CURRENT APPLICABLE STANDARDS AND SPECIFICATIONS OF THE VILLAGE OF INNSBROOK, MISSOURI, UNLESS OTHERWISE NOTED.
2. ALL WORKMANSHIP AND MATERIALS SHALL BE SUBJECT TO THE INSPECTION AND APPROVAL OF THE BUILDING DEPARTMENT OF THE VILLAGE OF INNSBROOK, MISSOURI.
3. PRIOR TO COMMENCEMENT OF WORK, THE CONTRACTOR SHALL NOTIFY ALL THOSE COMPANIES WHICH HAVE FACILITIES IN THE NEAR VICINITY OF THE CONSTRUCTION TO BE PERFORMED.
4. THE CONTRACTOR MAY UTILIZE THE FOLLOWING TOLL FREE PHONE NUMBER PROVIDED BY "MISSOURI ONE CALL SYSTEM, INC.: 1-(800)-DIG RITE. THIS PHONE NUMBER IS APPLICABLE ANYWHERE WITHIN THE STATE OF MISSOURI.
5. ALL DAMAGE TO EXISTING UTILITIES SHALL BE REPAIRED BY AND AT THE EXPENSE OF THE CONTRACTOR.
6. THE CONTRACTOR SHALL UNDER NO CIRCUMSTANCES CLEAR OR DAMAGE ANY TREES OUTSIDE THE CLEARING LIMIT LINE SET BY THE VILLAGE WITHOUT THE WRITTEN PERMISSION OF THE VILLAGE ENGINEER OR PROPERTY OWNER.
7. CLEARING AND GRUBBING OPERATIONS AND DISPOSAL OF ALL DEBRIS THEREFROM SHALL BE PERFORMED BY THE CONTRACTOR IN STRICT ACCORDANCE WITH ALL LOCAL CODES AND ORDINANCES.
8. THE CONTRACTOR SHALL KEEP THE STREETS CLEAN OF MUD AND DEBRIS.
9. THE CONTRACTOR SHALL PLACE MIN. 4" TOPSOIL AND SEED & MULCH (OR SOD) ON ALL DISTURBED AREAS UNLESS OTHERWISE NOTED.
10. DOWNSPOUTS SHALL NOT BE ALLOWED TO DISCHARGE ACROSS SIDEWALKS. ROUTE DOWNSPOUTS UNDER SIDEWALK AT ALL SIDEWALK LOCATIONS. SEE DETAIL ON SHEET 4

\* BUILDING DIMENSION NOTE:  
 CONTRACTOR SHALL VERIFY BUILDING DIMENSIONS WITH FOUNDATION AND METAL BLDG. PLANS PRIOR TO CONSTRUCTION.

\* SUGGESTED LOCATION ONLY, SUBJECT TO LOCAL AUTHORITY APPROVAL



### UTILITY DISCLAIMER

EXISTING UNDERGROUND UTILITIES AND BURIED STRUCTURES IN THE VICINITY OF THE WORK TO BE PERFORMED HEREIN ARE INDICATED ON THE DRAWINGS ONLY TO THE EXTENT THAT SUCH INFORMATION HAS BEEN MADE AVAILABLE TO OR DISCOVERED BY THE ENGINEER IN THE PREPARATION OF THE DRAWINGS. THERE IS NO GUARANTEE AS TO THE ACCURACY OR THE COMPLETENESS OF SUCH INFORMATION AND ALL RESPONSIBILITY FOR THE ACCURACY AND COMPLETENESS THEREOF IS EXPRESSLY DISCLAIMED.



NO.	DATE	DESCRIPTION	BY

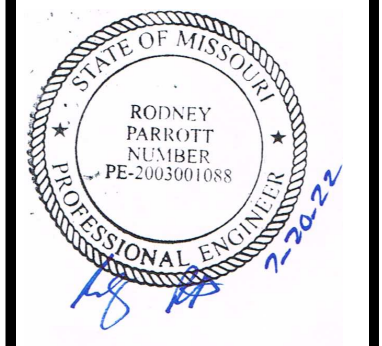

**Overland ENGINEERING, LLC**  
 1598 IMPERIAL CIR., STE. 2009 WEST PLAINS, MO 65775  
 PHONE: (417) 256-8150 FAX: (417) 256-8152  
 rusty@overlandeng.com

DOLLAR GENERAL  
 INNSBROOK, MO  
 SITE PLAN

SHEET  
**C1**

P:\Projects\11-1001 Overland Properties\1185 Innsbrook MO\Drawings\OG Innsbrook MO.dwg 08/09/2022 11:13 AM