

- NOTE:**
- ALL DIMENSIONS ARE FROM OUTSIDE EDGE OF EXTERIOR WALL SHEATHING OR FACE OF STUD, U.N.O.
  - ALL DOOR & WINDOW HEADERS IN EXTERIOR WALLS TO BE (2) 2X8 U.N.O.
  - ALL INTERIOR DOOR HEADERS TO BE (2) 2X4, U.N.O.
  - PROVIDE PRESSURE TREATED LUMBER @ HOUSE BAND WHERE ALL DECK, PORCH & APPURTENANCES ARE CONNECTED.
  - EVERY SLEEPING ROOM SHALL HAVE AT LEAST ONE WINDOW WITH MIN. NET CLEAR OPENING OF 5.7 SQUARE FEET (5.0 SQUARE FEET FOR GRADE FLOOR WINDOWS) WITH A MINIMUM NET CLEAR WIDTH AND HEIGHT DIMENSIONS OF 20 INCHES AND 24 INCHES, RESPECTFULLY. THE SILL HEIGHT SHALL NOT BE GREATER THAN 44 INCHES.
  - SMOKE DETECTORS INSTALLED IN A NEW DWELLING SHALL BE INTERCONNECTED AND SHALL RECEIVE THEIR PRIMARY POWER BY PERMANENT CONNECTION TO THE DWELLING ELECTRICAL SYSTEM AND WHEN PRIMARY POWER IS INTERRUPTED, SHALL RECEIVE POWER FROM A BATTERY.

the house band and sill shall be pressure treated where decks, porches and other appurtenances are attached

Attach deck header to pressure treated house band per Table R502.2.2.1

**\*IMPORTANT\***  
See new IRC 2012 construction code. Decks must be constructed per the details and tables as shown in the code.

ELECTRICAL LEGEND			
	SINGLE POLE SWITCH		DOOR BELL BUTTON
	3-WAY SWITCH		DOOR BELL CHIME
	4-WAY SWITCH		GARAGE DOOR BUTTON
	DIMMER SWITCH		GARAGE DOOR OPENER
	220 VOLT OUTLET		WEATHERPROOF OUTLET
	DUPLEX OUTLET		CEILING OUTLET
	GROUND FAULT OUTLET		FLOOR OUTLET
	SMOKE DETECTOR		CARBON MONOXIDE & SMOKE DETECTOR COMBO
	CARBON MONOXIDE DETECTOR		NETWORK OUTLET
	TELEVISION OUTLET		TELEPHONE OUTLET
	SERVICE PANEL		GARBAGE DISPOSAL
	SERVICE METER		ACCENT LIGHT
	WALL MOUNT LIGHT		SINGLE SCONCE
	FLOOD LIGHT		DOUBLE SCONCE
	STRIP LIGHT		STAIR LIGHT
	BATH FAN & LIGHT COMBO		BATH FAN
	CLOSET CASTER LIGHT		UNDER CABINET LIGHT
	PULL CHAIN LIGHT		KEYLESS LIGHT
	FLUSH MOUNT LIGHT		HANGING LIGHT
	HANGING PENDANT LIGHT		MINIATURE PUCK LIGHT
	RECESSED CAN LIGHT		RECESSED EYEBALL LIGHT
	FLUORESCENT LIGHT RECTANGULAR		FLUORESCENT LIGHT ROUND
	CEILING FAN		LIGHT w/ FAN ROUGH
	LIGHTED CEILING FAN		LIGHT & FAN ROUGH

**Electrical Legend**  
1/8" = 1'-0" WHEN PRINTED ON 11"x17" / ANSI B PAPER SIZE

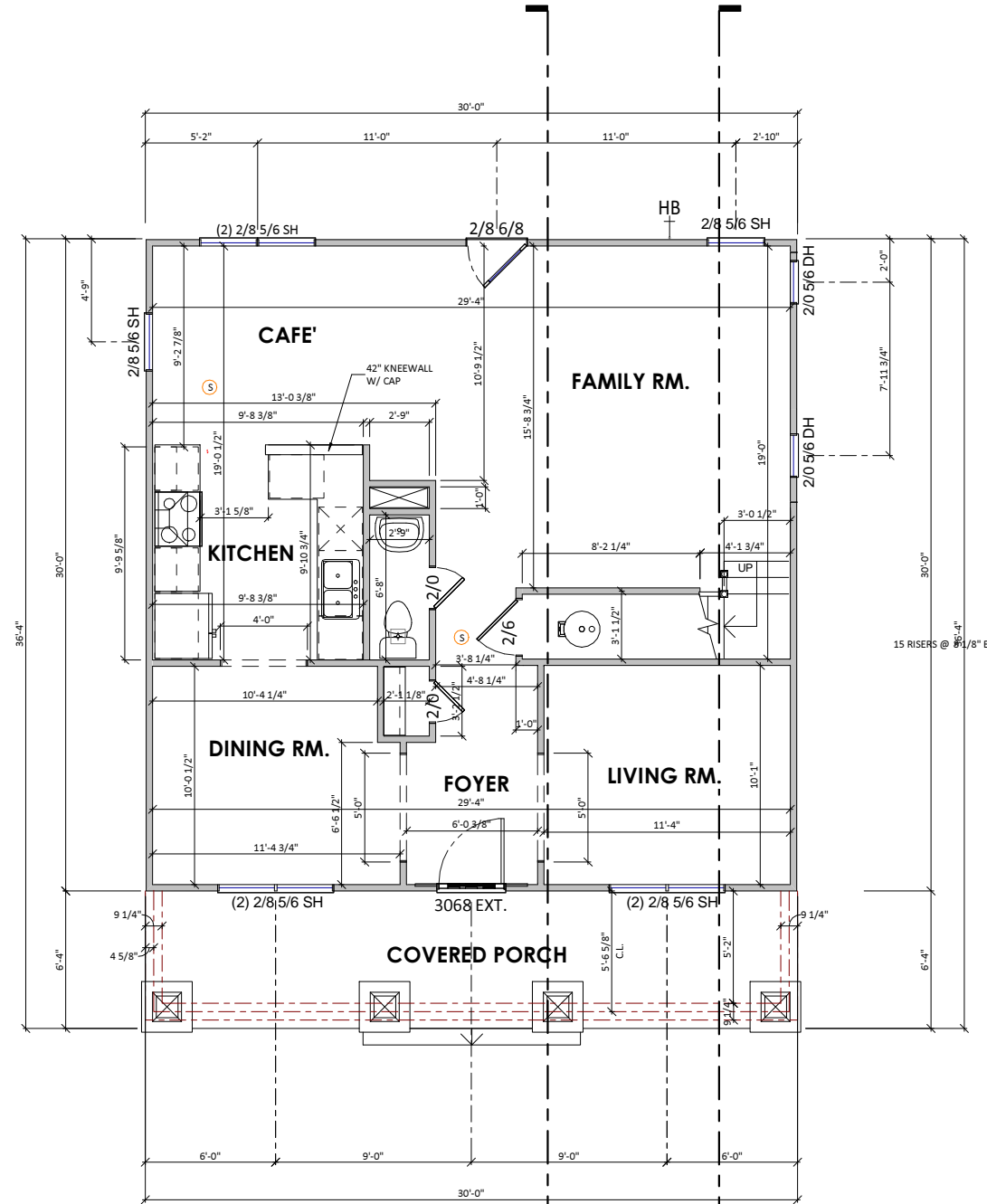

**1 First Floor Plan**  
A-2.10 1/8" = 1'-0" WHEN PRINTED ON 11"x17" / ANSI B PAPER SIZE

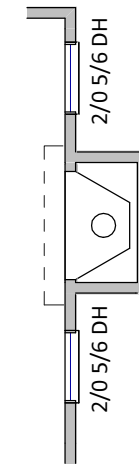

**2 Fireplace w/ Window Opt.**  
A-2.10 3/16" = 1'-0" WHEN PRINTED ON 11"x17" / ANSI B PAPER SIZE

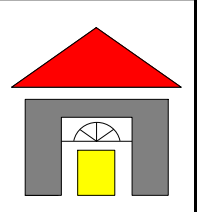

4114 Dartmoor Court  
Fredericksburg,  
Virginia 22408  
  
(P): 540-841-7320  
(E): thegreenstudio1@gmail.com

NO.	DATE	REVISIONS	REMARKS

CLIENT: **THE FARMHOUSE II**  
SUBDIVISION:   
LOT NO.:

PROJECT: **2 STORY PLAN**  
SERIES:   
SHEET: **First Floor Plan**

ISSUE DATE: **10/17/2017**  
DRAWN BY: **AGE/ 841.7230**  
SHEET NUMBER: **A-2.10**

- NOTE:
- ALL DIMENSIONS ARE FROM OUTSIDE EDGE OF EXTERIOR WALL SHEATHING OR FACE OF STUD, U.N.O.
  - ALL DOOR & WINDOW HEADERS IN EXTERIOR WALLS TO BE (2) 2X8 U.N.O.
  - ALL INTERIOR DOOR HEADERS TO BE (2) 2X4, U.N.O.
  - PROVIDE PRESSURE TREATED LUMBER @ HOUSE BAND WHERE ALL DECK, PORCH & APPURTENANCES ARE CONNECTED.
  - EVERY SLEEPING ROOM SHALL HAVE AT LEAST ONE WINDOW WITH MIN. NET CLEAR OPENING OF 5.7 SQUARE FEET (5.0 SQUARE FEET FOR GRADE FLOOR WINDOWS) WITH A MINIMUM NET CLEAR WIDTH AND HEIGHT DIMENSIONS OF 20 INCHES AND 24 INCHES, RESPECTFULLY. THE SILL HEIGHT SHALL NOT BE GREATER THAN 44 INCHES.
  - SMOKE DETECTORS INSTALLED IN A NEW DWELLING SHALL BE INTERCONNECTED AND SHALL RECEIVE THEIR PRIMARY POWER BY PERMANENT CONNECTION TO THE DWELLING ELECTRICAL SYSTEM AND WHEN PRIMARY POWER IS INTERRUPTED, SHALL RECEIVE POWER FROM A BATTERY.

**\*IMPORTANT\***  
 See new IRC 2012 construction code.  
 Decks must be constructed per the details and tables as shown in the code.

Attach deck header to pressure treated house band per Table R502.2.2.1

the house band and sill shall be pressure treated where decks, porches and other appurtenances are attached

ELECTRICAL LEGEND			
	SINGLE POLE SWITCH		DOOR BELL BUTTON
	3-WAY SWITCH		DOOR BELL CHIME
	4-WAY SWITCH		GARAGE DOOR BUTTON
	DIMMER SWITCH		GARAGE DOOR OPENER
	220 VOLT OUTLET		WEATHERPROOF OUTLET
	DUPLEX OUTLET		CEILING OUTLET
	GROUND FAULT OUTLET		FLOOR OUTLET
	SMOKE DETECTOR		CARBON MONOXIDE & SMOKE DETECTOR COMBO
	CARBON MONOXIDE DETECTOR		DATA NETWORK OUTLET
	TELEVISION OUTLET		TELEPHONE OUTLET
	SERVICE PANEL		GARBAGE DISPOSAL
	SERVICE METER		ACCENT LIGHT
	WALL MOUNT LIGHT		SINGLE SCONCE
	FLOOD LIGHT		DOUBLE SCONCE
	STRIP LIGHT		STAIR LIGHT
	BATH FAN & LIGHT COMBO		BATH FAN
	CLOSET CASTER LIGHT		UNDER CABINET LIGHT
	PULL CHAIN LIGHT		KEYLESS LIGHT
	FLUSH MOUNT LIGHT		HANGING LIGHT
	HANGING PENDANT LIGHT		MINIATURE PUCK LIGHT
	RECESSED CAN LIGHT		RECESSED EYEBALL LIGHT
	FLUORESCENT LIGHT RECTANGULAR		FLUORESCENT LIGHT ROUND
	CEILING FAN		LIGHT w/ FAN ROUGH
	LIGHTED CEILING FAN		LIGHT & FAN ROUGH

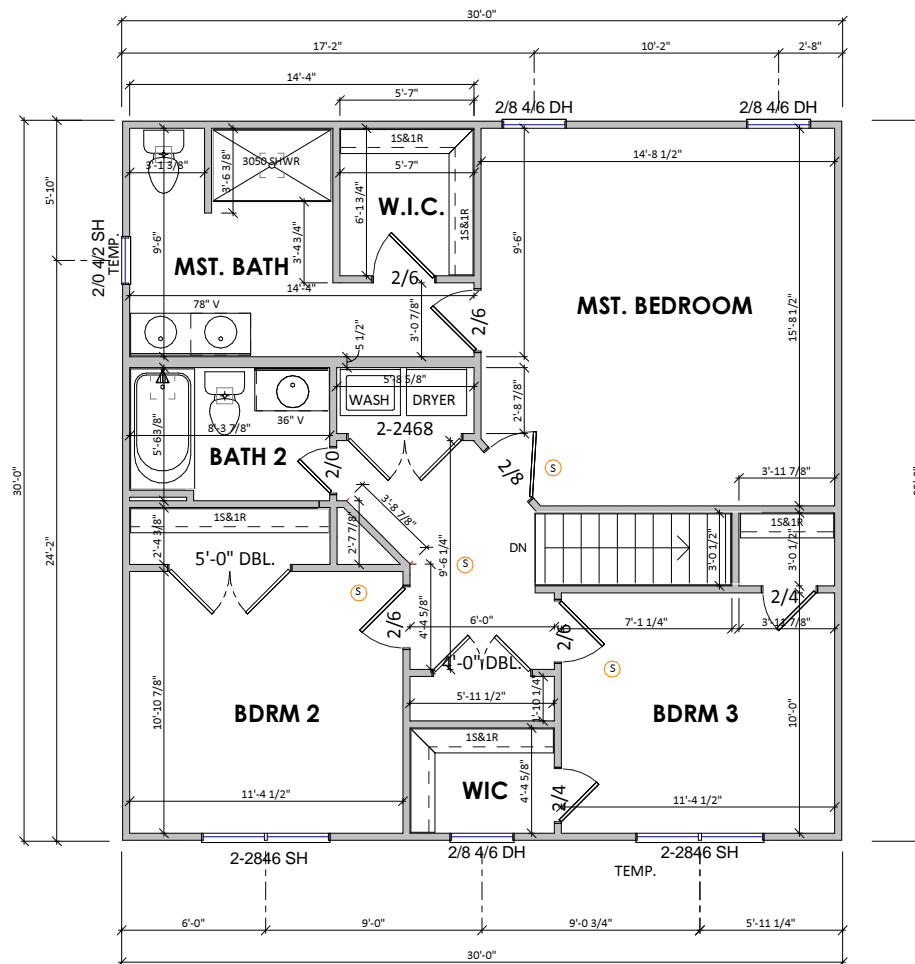

**1 Second Floor Plan**  
 A-2.20 1/8" = 1'-0" WHEN PRINTED ON 11"x17" / ANSI B PAPER SIZE

**Electrical Legend**  
 1/8" = 1'-0" WHEN PRINTED ON 11"x17" / ANSI B PAPER SIZE

4114 Dartmoor Court  
 Fredericksburg,  
 Virginia 22408  
 (P): 540-841-7320  
 (E): thegreenstudio1@gmail.com

NO.	DATE	BY	REVISIONS	REMARKS

CLIENT: **THE FARMHOUSE II**  
 SUBDIVISION:   
 LOT NO.:

PROJECT: **2 STORY PLAN**  
 SERIES:   
 SHEET: **Second Floor Plan**

ISSUE DATE: **10/17/2017**  
 DRAWN BY: **AGE/ 841.7230**  
 SHEET NUMBER: **A-2.20**