



JD NO-TILL DRILL & AIR SEEDER PARTS



PART #	MODEL	DESCRIPTION	PRICE EA.
5203KYY2-I	750-1990	40 MM. GAUGE WHEEL BEARING	\$ 8.95
SS203KRR2	750	OEM PRESS WHEEL BEARING STAINLESS STEEL	\$ 8.95
203KRR2	750	OEM PRESS WHEEL BEARING	\$ 6.95
K750A	750-1850	CLOSING WHEEL BEARING SET	\$ 13.95
5203TN1	750-1850	CLOSING WHEEL BEARING	\$ 11.95
BK750K	750-1850	HUB BEARING KIT	\$ 21.95
P281813	1560-1990	HUB BEARING	\$ 29.75
AN213544	750-1850	HUB W/ CUPS	\$ 36.75
CN283291A	1560-1990	HUB W/ BEARING	\$ 57.95
K18750D	750-1990	18" OPENER OEM *HAS FULL 11/16" BEVEL	\$ 27.95 SALE
P280446	750-1850	SEED BOOT RIGHT	\$ 32.95 SALE
P280447	750-1850	SEED BOOT LEFT	\$ 32.95 SALE
BH381525	750-1850	SEED BOOT BOLT	\$ 2.75
C145WS	750-1990	HD POLY FIRING STRIP	\$ 2.50
G281015	750-1590	PLASTIC SEED TUBE	\$ 10.50
P283432SMA	1560-1860	SEED BOOT BOTTOM RIGHT	\$ 19.75 SALE
P283433SMA	1560-1860	SEED BOOT BOTTOM LEFT	\$ 19.75 SALE
P282788K	1560-1860	SEED BOOT TOP RIGHT	\$ 18.95 SALE
P282789K	1560-1860	SEED BOOT TOP LEFT	\$ 18.95 SALE
C185WS60	1560-1860	SEED BOOT FIRING STRIP	\$ 1.65
P28044	1590-1990	SEED BOOT RIGHT	\$ 38.95 SALE
P28045	1590-1990	SEED BOOT LEFT	\$ 38.95 SALE
C185WS	750-1990	POLY FIRING STRIP	\$ 1.50
G283739	1590	SEED TUBE LH FRONT	\$ 14.95
G283738	1590	SEED TUBE RH FRONT	\$ 14.95
CN284085	750-1990	BOOT LEAF SPRING	\$ 3.95
CN282118	1560-1990	HUB SPINDLE RIGHT	\$ 25.95
BH283800		SPINDLE NUT RIGHT	\$ 3.95
CN282119	1560-1990	HUB SPINDLE LEFT	\$ 25.95
BH283801		SPINDLE NUT LEFT	\$ 4.95
P280725	750-1850	OPENER SPINDLE W/ ADJUSTMENT PLATE	\$ 59.50
CN282117	1560-1990	DEPTH ARM W/ SHAFT	\$ 42.75
P282374-K	750-1850	GAUGE WHEEL ARM	\$ 39.95
H110	750-1560	1" X 10" PRESS WHEEL TIRE USA	\$ 8.50
H11031	750-1890	1" X 10" WHEEL ASSEMBLY	\$ 25.75
P282296	1590+	1" X 9" V-CROWN TIRE	\$ 27.50
H33297	EARLY 750	1" X 12" PRESS TIRE ASSEMBLY	\$ 32.95





JD NO-TILL DRILL & AIR SEEDER PARTS

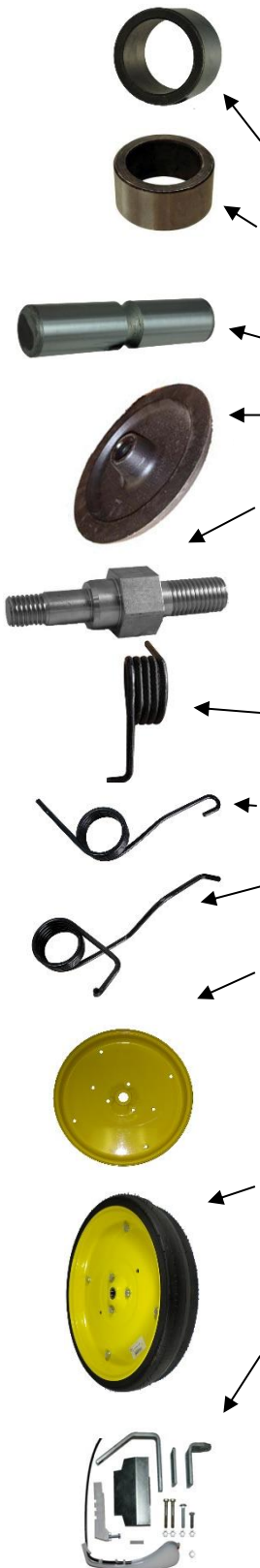

PART #	MODEL	DESCRIPTION	PRICE EA.
CN280648	750-SN 6001> 1560-1990	PIVOT BUSHING FOR CLOSING ARM 3 3/8" X 1"ID	\$ 9.95
CN218646	750-1850	OUTER/ UPPER PIVOT BUSHING	\$ 6.95
CN283636	1560-1990	PIVOT BUSHING FOR OUTER / UPPER OPENER ARM	\$ 4.95
CN219547	750 SN:3835> 1560-1990	PIVOT BUSHING FOR OUTER PRESS WHEEL & OPENER ARM	\$ 3.95
CN284086	1560+	TOP INNER BUSHING FOR PRESS WHEEL 2 3/8" X 1"	\$ 9.50
CN280486	750-1850	PIVOT PIN FOR INNER/UPPER ARM	\$ 17.95
CN282536	1560-1990	PIVOT PIN FOR INNER/UPPER ARM	\$ 16.95
CAST750	750-1850	CAST IRON CLOSING WHEEL W/ BEARINGS	\$ 50.95
CAST1890	1560-1990	CAST IRON CLOSING WHEEL	\$ 46.95
CN280564	750 SN:5673>	CLOSING WHEEL SPINDLE (RH)	\$ 30.50
CN280565	750 SN:5673>	CLOSING WHEEL SPINDLE (LH)	\$ 30.50
C538266	750	CAST CLOSING WHEEL SEAL	\$ 3.95
SCW75B	750-1850	MARTIN SPADE WHEEL KIT	\$ 134 SALE
SCW156D	1560-1995	MARTIN DIMPLE WHEEL KIT	\$ 82 SALE
CN214510	750-1850	TORSION SPRING FOR CLOSING AND PRESS WHEEL RIGHT	\$ 10.95
CN214511	750-1850	TORSION SPRING FOR CLOSING AND PRESS WHEEL LEFT	\$ 10.95
CN282218	1560-1990	TORSION SPRING PRESS WHEEL (RIGHT)	\$ 13.50
CN282219	1560-1990	TORSION SPRING PRESS WHEEL (LEFT)	\$ 13.50
P283994	1560-1990	TORSION SPRING FOR CLOSING WHEEL (RIGHT)	\$ 9.95
P283995	1560-1990	TORSION SPRING FOR CLOSING WHEEL (LEFT)	\$ 9.95
864-704223	750	YELLOW GAUGE WHEEL RIM HALF METAL	\$ 14.95 SALE
864-8570B	1560	BLACK GAUGE WHEEL RIM HALF METAL	\$ 14.95 SALE
H204008	750-1560	GAUGE WHEEL TIRE USA	\$ 26.95 SALE
H32020	1590-1995	GAUGE WHEEL TIRE	\$ 30.95 SALE
H29548	SEVERAL	RID GAUGE TIRE USA	\$ 31.95 SALE
864-98Y	750	GAUGE TIRE ASSEMBLY W/ 40MM. BEARING	\$ 73.95
864-140B	1560-1990	GAUGE TIRE ASSEMBLY W/ 40MM. BEARING W/ COVER	\$ 85.00
013-4516XPB	1995	GAUGE TIRE ASSEMBLY W/ 40MM. BEARING W/ POLY OUTER COVER	\$ 79.95
HRDG-WP	SEVERAL	POPULATION SENSOR	\$ 85.00 SALE
120133	750-1850	KEETON FIRMER KIT	\$ 35.50 SALE
120134	1560-1990	KEETON FIRMER KIT	\$ 35.50 SALE

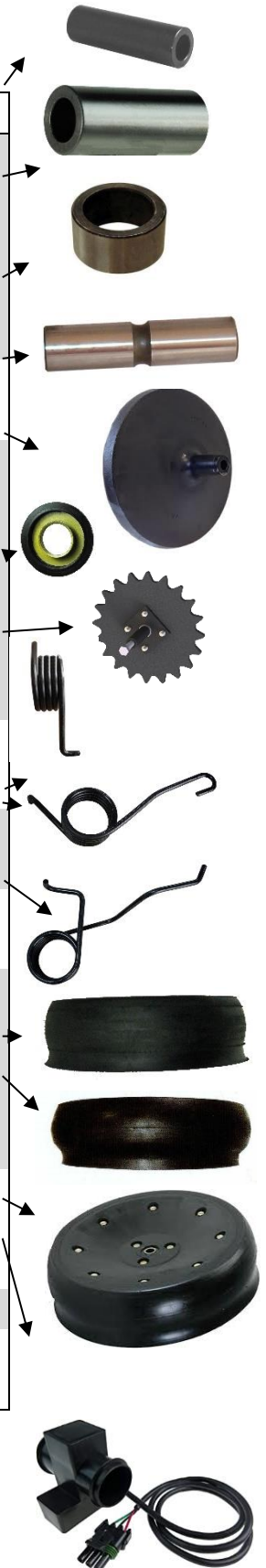

PRICES SUBJECT TO CHANGE WITHOUT NOTICE!

