

QUICK PROGRAMMING GUIDE FOR MAESTRIA™ 50 RTS MOTORS



50mm motor diameter



Side View

FACTORY MODE

STOP BEFORE YOU BEGIN

Motors are shipped in FACTORY MODE without limit settings and the transmitter ID's. Power must ONLY be connected to current screen being programmed. All other screens must be disconnected from their respective power while programming.



Note - If motor is 120V AC hardwired and cannot be disconnected, please contact an electrician prior to calling Somfy customer service for assistance.

CONNECT TO POWER MODE

With the motor installed in the screen, connect power to the motor (120V AC).

While programming, screens should not be inactive for longer than 2 minutes or motor will exit PROGRAMMING MODE.

INITIATE PROGRAMMING

On the transmitter, briefly press both UP and DOWN simultaneously: the screen jogs.



CHECK THE DIRECTION OF OPERATION

STOP If hand-held transmitter direction is not properly programmed, Eolis/Soliris RTS sensor will not function in the manner it was intended. Damage to the screens and injury may occur as a result.

Check the direction of rotation by pressing UP or DOWN.

If necessary change the direction of rotation by simply pressing and holding the MY button until the screen jogs.

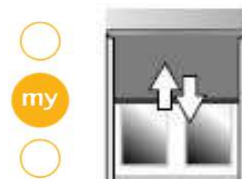

QUICK PROGRAMMING GUIDE FOR MAESTRIA™ 50 RTS MOTORS

PROGRAMMING MODE

MANUAL ADJUSTMENT OF THE END LIMITS

- 1) Position the screen at the desired UPPER Limit
- 2) Press MY and DOWN simultaneously:
the screen lowers.
- 3) Position the screen at the desired LOWER Limit.
- 4) Press MY and UP simultaneously:
the screen raises.
- 5) Press MY until the screen jogs to
validate the end limit setting.



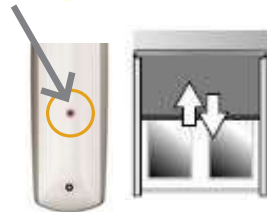

To EXIT PROGRAMMING and switch to USER MODE briefly press the PROG button on the control: the screen jogs; the control is programmed.

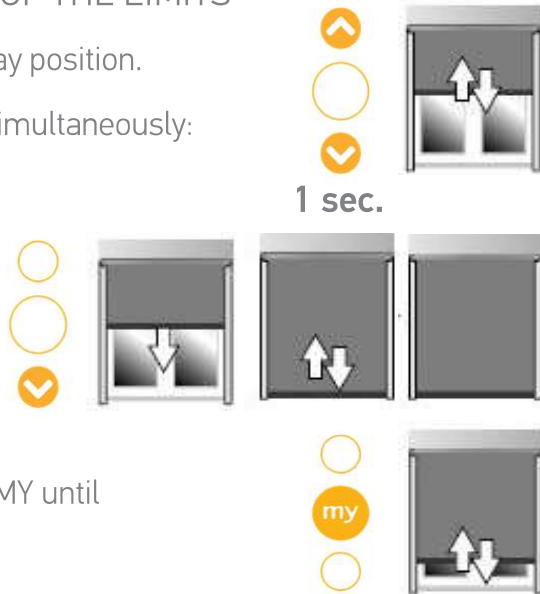

AUTOMATIC ADJUSTMENT OF THE LIMITS*

- 1) Bring the screen to its half-way position.
- 2) Briefly press UP and DOWN simultaneously:
the screen jogs.
- 3) Press the DOWN button:
the screen lowers until it detects the LOWER Limit, performs a brief upward movement and returns to its LOWER Limit position.
- 4) To validate the setting, press MY until the screen jogs.



 *If the lower end limit is not set automatically after several attempts, restart the setting and perform the step on the following page.*

To EXIT PROGRAMMING and switch to USER MODE briefly press the PROG button on the control: the screen jogs; the control is programmed.



QUICK PROGRAMMING GUIDE FOR MAESTRIA™ 50 RTS MOTORS

SEMI-AUTOMATIC LIMIT ADJUSTMENT* (The LOWER limit is set manually and the UPPER limit is set automatically)

- 1) Position the screen at the desired LOWER Limit.
- 4) Press MY and UP simultaneously: the screen raises.
- 5) Press MY to stop the screen.
- 6) Press MY until the screen jogs to validate the LOWER Limit setting.

To EXIT PROGRAMMING and switch to USER MODE briefly press the PROG button on the control: the screen jogs; the control is programmed.

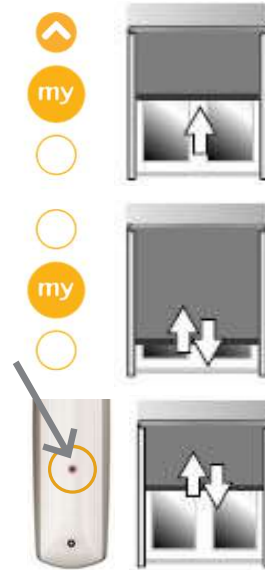

*** The UPPER Limit in AUTOMATIC and SEMI-AUTOMATIC MODE is automatically calculated during the first 4 cycles in the USER MODE. After those 4 cycles Maestria will stop at the UPPER end. The motor will automatically recalculate the UPPER limit on regular basis, compensating any fabric extension.**

MANUAL ADJUSTMENT OF THE LOWER END LIMIT AND AUTOMATIC ADJUSTMENT OF THE UPPER END LIMIT WITH AUTOMATIC CATCHING SYSTEM (LOCK SYSTEM)

 The catching system at the lower end limit may vary depending on the driven product, but the procedure for setting the entrance/exit positions of the catches remains the same on all systems.

- 1) Starting from half-way position press and hold UP and DOWN simultaneously for 5 seconds until a slow up and down movement.



- 2) Press the DOWN button: the screen lowers.

- 3) Press the MY button to stop the screen at position (P1), which corresponds to the automatic catching system's entrance point.

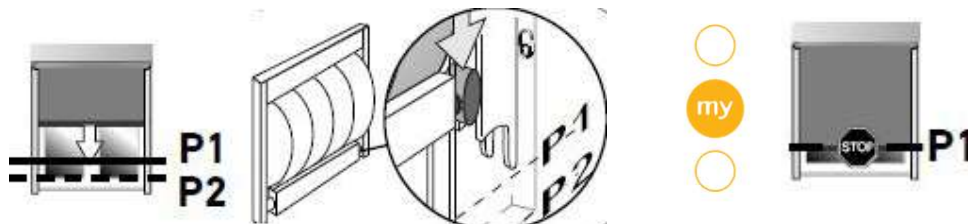

QUICK PROGRAMMING GUIDE FOR MAESTRIA™ 50 RTS MOTORS

- 4) Press MY and UP simultaneously:
the screen raises and stops,
putting tension on the fabric.

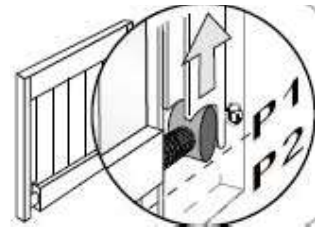

- 6) Press the DOWN button: the screen lowers.

- 7) Press the MY button to stop the screen at position (P2), which corresponds to the automatic catching system's exit point.

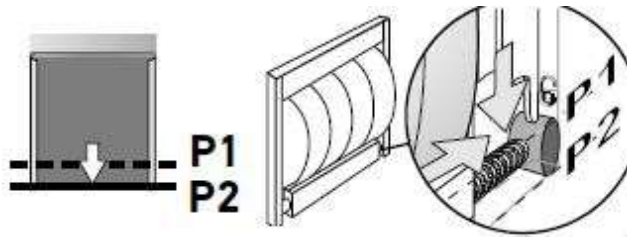

- 8) Press MY until the screen jogs.
to validate the end limit setting.

To EXIT PROGRAMMING and switch to USER MODE briefly press the PROG button on the control:
the screen jogs; the control is programmed.

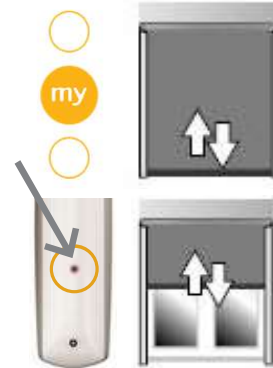

MANUAL ADJUSTMENT OF END LIMITS WITH THE AUTOMATIC CATCHING SYSTEM

 The catching system at the lower end limit may vary depending on the screen product, but the procedure for setting the entrance/exit positions of the catches remains the same on all systems.

- 1) Starting from half-way position press and hold UP and DOWN simultaneously for 5 seconds until it jogs.

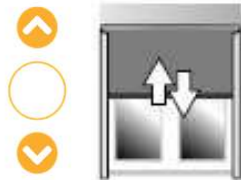

- 3) Press the UP button: the screen raises.

- 4) Press MY to stop the screen at the UPPER Limit (adjust if necessary).



- 5) Press MY and DOWN simultaneously: the screen lowers.

- 6) Press the MY button to stop the screen at position (P1), which corresponds to the automatic catching system's entrance point.



QUICK PROGRAMMING GUIDE FOR MAESTRIA™ 50 RTS MOTORS

7) Press MY and UP simultaneously:
the screen raises and stops, putting tension on the fabric.

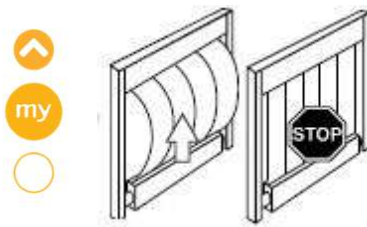

8) Press the DOWN button:
the screen lowers.

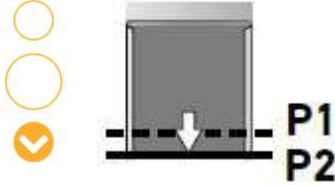

9) Press the MY button to stop the screen
at position (P2), which corresponds to
the automatic catching system's exit point.



10) Press MY until the screen jogs
to validate the end limit setting.

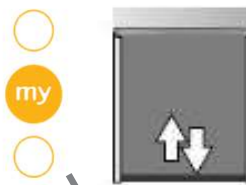

To EXIT PROGRAMMING and switch to USER MODE
briefly press the PROG button on the control:
the screen jogs; the control is programmed.

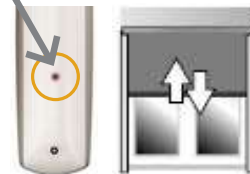

USER MODE

ADJUSTING THE LIMITS IN USER MODE PROGRAMMING OF A NON-PRE-PROGRAMMED CONTROL POINT

1) Switch off the power supply (the pre-programmed transmitter is deleted).

2) Switch the main power supply back on. The screen jogs.

3) Simultaneously press the UP and DOWN
buttons of the control to be programmed
until the screen jogs.

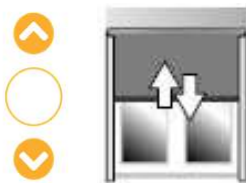

4) Briefly press the PROG button of this control:
the screen jogs; the control is programmed.

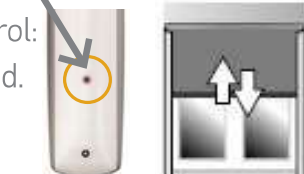

QUICK PROGRAMMING GUIDE FOR MAESTRIA™ 50 RTS MOTORS

OBSTACLE DETECTION



This function gives the possibility to deactivate the obstacle detection or increase the sensitivity up from the default level during the downward movement.

When programming, all button presses must be completed within 2 seconds of the previous press.

1. ENTER THE OBSTACLE SETTING MODE

Move the screen to half-way position, press MY and UP briefly and again MY and UP until the screen jogs.

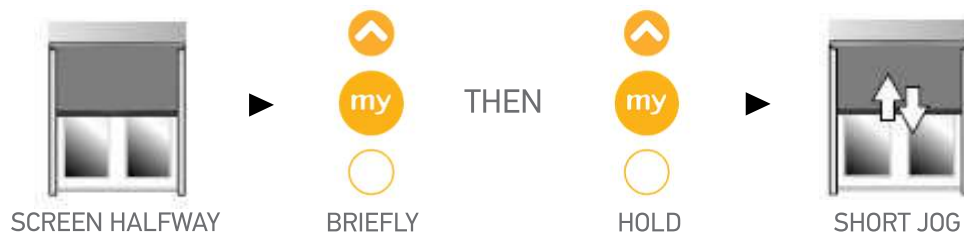

2. CHANGE THE OBSTACLE DETECTION LEVEL

If the actuator goes back to USER MODE (short jog) repeat Step 1.

To Deactivate:

Press UP briefly within 2 seconds and then press UP briefly again. The screen will jog slowly and is now deactivated.

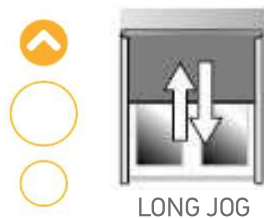

IF THE JOG IS SHORT YOU'VE REACHED THE DEFAULT SETTING. TO DEACTIVATE PRESS UP AGAIN.

To Increase Sensitivity:

Press DOWN briefly within 2 seconds and then press DOWN briefly again. The screen will jog slowly and is now deactivated.



IF THE JOG IS SHORT YOU'VE REACHED THE DEFAULT SETTING. TO INCREASE SENSITIVITY PRESS DOWN AGAIN

3. CONFIRM THE NEW SETTING & EXIT THE SETTING MODE

Press MY/STOP until the screen jogs to confirm the new setting.



The registered level of Obstacle Detection will be reached when entering Step 1 again.