

WindowTherm®
40mm Window Wall System
Installation Instructions

Solutions in Polycarbonate LLC

6553 Norwalk Road
Medina, Ohio 44256
Ph. 330-572-2860 Fax 330-572-2861

Project Name: _____

Project Location: _____

Customer Name: _____

NOTE: THIS IS A REPRODUCTION OF A SOLUTIONS
IN POLYCARBONATE DRAWING AND IS SUPPLIED ONLY
FOR AUTHORIZED PROJECT. THIS MUST NOT BE USED
FOR CONSTRUCTION OR FABRICATION UNTIL SIGNED
AS CHECKED AND ISSUED FOR PRODUCTION.

INDEX/CONTENT

Included with the WindowTherm™ Window Wall System:

- Latest approved file and field drawings
- Installation manual
- Parts and hardware list
- Glazing sizes sheet
- Care and Maintenance Manual

- PG 1.) VERIFY OPENING DIMENSIONS AND SQUARENESS
- PG 2.) INSTALLATION OF GASKET AND CORNER KEY
- PG 3.) INSTALLING BASE FRAME TO OPENING
- PG 4.) INSTALLING HEAD BASE FRAME AND SPLICE JOINTS
- PG 5.) CONTINUATION OF BASE FRAME INSTALLATION
- PG 6.) INSTALLING FIRST GLAZING PANEL
- PG 7.) PANEL INSTALLATION DETAILS
- PG 8.) LAST PANEL INSTALLATION
- PG 9.) SEALING PERIMETER.

WARNING BE AWARE OF

FALL HAZARDS
CONTRACTOR RESPONSIBILITIES
OSHA COMPLIANCE

INTRODUCTION

The information contained within this installation manual is intended to give an overview of the basic WindowTherm Window Wall System™ installation processes and methods of installation that will need to be followed in order to successfully complete a quality, leak free Window Wall system installation.

The installation processes, methods and details that are described within this manual have been developed and used by skilled erectors over the course of years of successful window, wall systems and curtain wall installations and should be used whenever possible for a smooth, quality installation. Where special cases exist, additional information will be furnished and enclosed in the document envelope.

If there is ever a question during the course of the wall system installation that cannot be answered by this manual or the file and field drawings please contact Solutions In Polycarbonate LLC at 330-416-3200

GENERAL INFORMATION

UNLOADING:

Your care of the WindowTherm™ Window Wall System framing material and glazing material starts with the unloading of the shipment. Unloading should be organized and correct machinery and manpower used to minimize the material handling.

If hoisting is required by either crane or forklift, the framing material and glazing weight should be considered and evenly distributed to prevent distorting or damaging the material.

Crates are for shipping purposes only and should not be relied upon for hoisting.

INSPECTION:

Upon receipt, you should inspect the shipment to ensure that the framing material and or glazing material were not damaged during shipping. If damage is visible, note it on the bill of lading and contact Solution In Polycarbonate LLC as soon as possible at 1-330-572-2860

Count material and check it against the parts list and hardware list. If there is a shortage contact Solutions In Polycarbonate LLC immediately at 1-330-572-2860

STORAGE:

All material placed on the job site must be stacked level and follow the directional arrows on the crates.

When placing materials on the roof, it is the installer/contractor responsibility to make sure the roofing material is not damaged and the weight of the wall system framing and glazing is distributed across the roof. Check with contractor for roof point loading capabilities.

All stored material MUST be covered and kept dry. If the material is allowed to get wet, it can stain the finished material, especially mill finish material.

It is the installer/contractor responsibility to protect all materials until they are installed, unless otherwise specified.

GENERAL:

These instructions have been furnished to assist with the installation. To the best of our knowledge they are correct. Each installation is unique and attention must be given to the approved file and field drawings furnished specifically for this project. Solutions In Polycarbonate LLC expect our installers to be knowledgeable and complete all work professionally, to industry standards.

TOOLS

- 1/2" Electric drill
- 1/2" Cordless drill/driver
- Corded or cordless Sawsall
- Saber saw
- Compound miter saw
- 8" Diameter suction cups (Woods Pow-R-Grip) for larger panels
- Aviation snips (left, right and straight)
- Claw hammer
- Flat bar
- Rubber mallet
- Pop-rivet gun
- Caulking gun(s) [manual and or powered]
- Razor scraper(s)
- Hex power nut driver 1/4", 5/16", 3/8" and 7/16"
- Extension cords (100' and 50')
- Craftsman Handi-Cut or similar cutting tool
- Utility knives
- Tape measure (30')
- Spatula
- Ratchet straps
- Gloves
- Safety glasses
- Fall protection equipment

INSTALLER FURNISHED ITEMS

- Silicone sealant compatible with the glazing material as recommended by Solutions In Polycarbonate LLC. Dow Corning 795 or Dow Corning CW5 is the preferred sealant. If another brand is to be used please check with Solutions In Polycarbonate prior to applying.
- Compressible fillers, shims and insulation if required.
- Masking tape.
- Any and all protective material that will be required.
- Tools

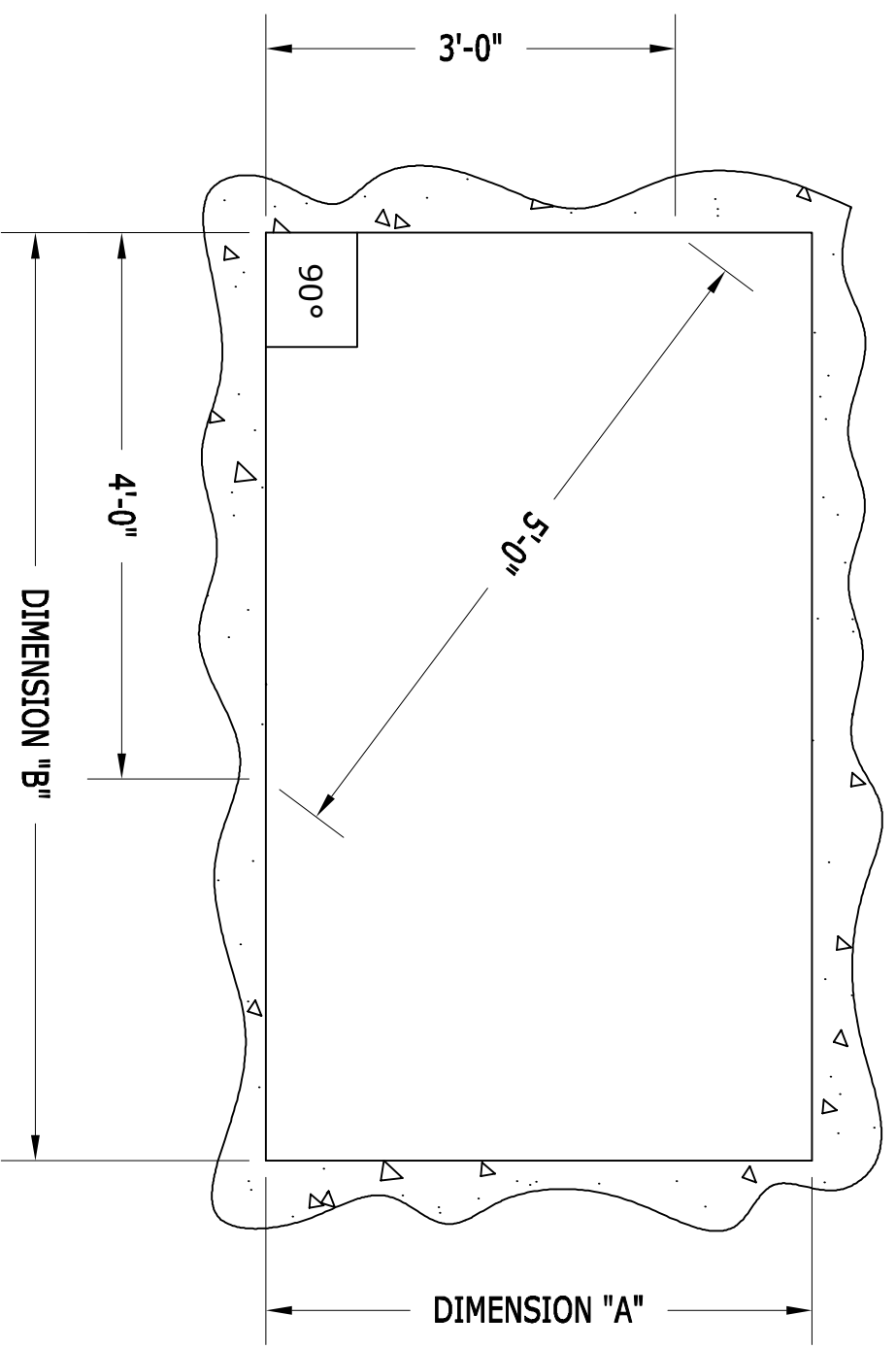
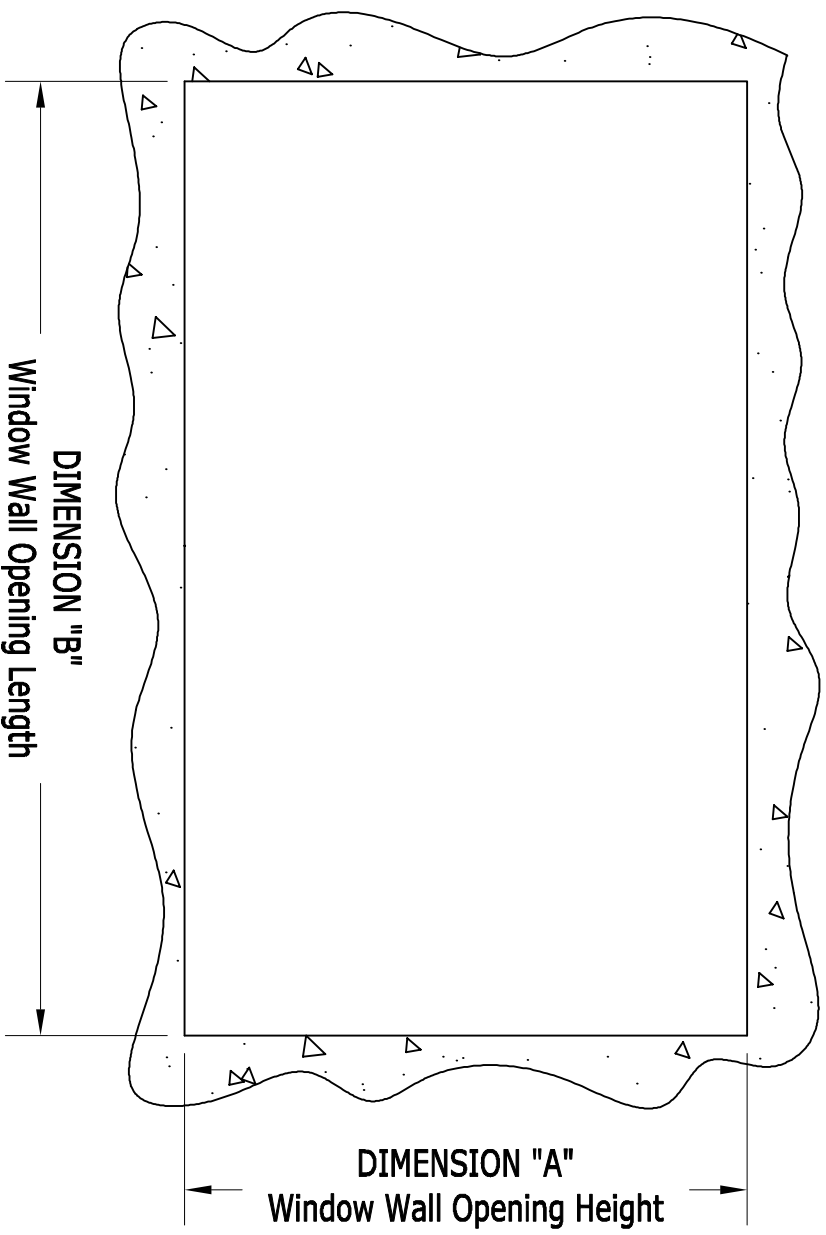

STEP ONE:

- 1.) Prior to starting the installation verify the the opening dimension with the approved shop drawings sent with the material.
- 2.) Verify that the opening is square. The use of the 3, 4, 5 method works well in field conditions. Make sure to verify each corner.
- 3.) Verify that the opening is flat, level and plumb.

Solutions in Polycarbonate

6553 Norwalk Road, Medina, Ohio 44256
 Phone 330-572-2860, Fax 330-572-2861

Project Name: ****
Project Location: ****
Customer Name: ****

WindowTherm[™]
40mm Window Wall System
Installation Instructions

STEP TWO:

- 1.) Insert the low friction gasket (BLUE) into the pressure cap. See Fig 1 Insert the low friction gasket (RED) into base extrusion after base is anchored to substrate and prior to installing glazing panels.
- 2.) Insert the corner key into each end of the jamb base extrusion. See Fig 2 and Fig 2A

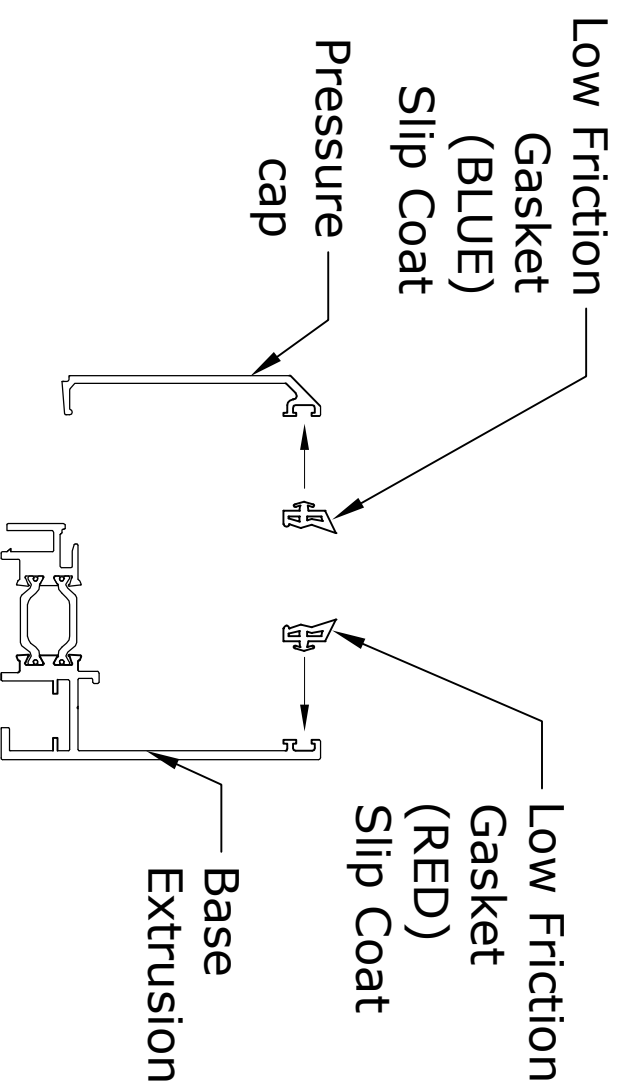

Fig 1

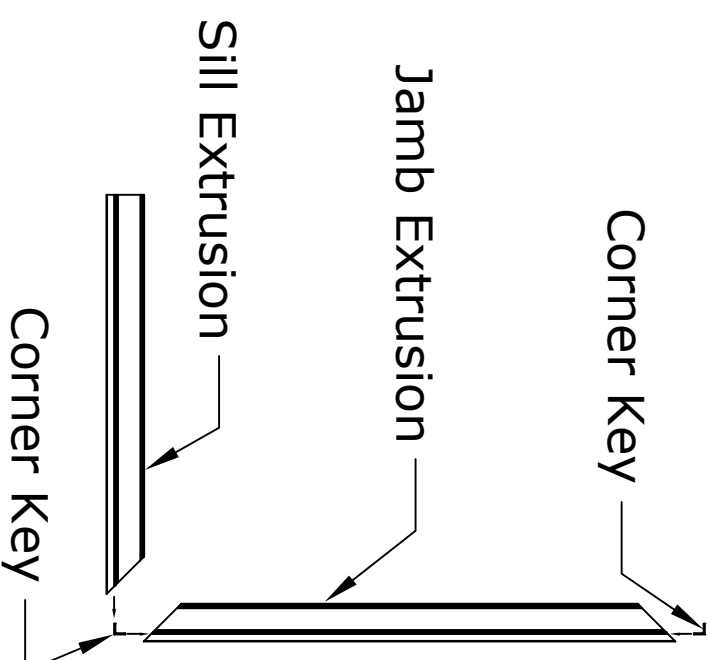

Fig 2

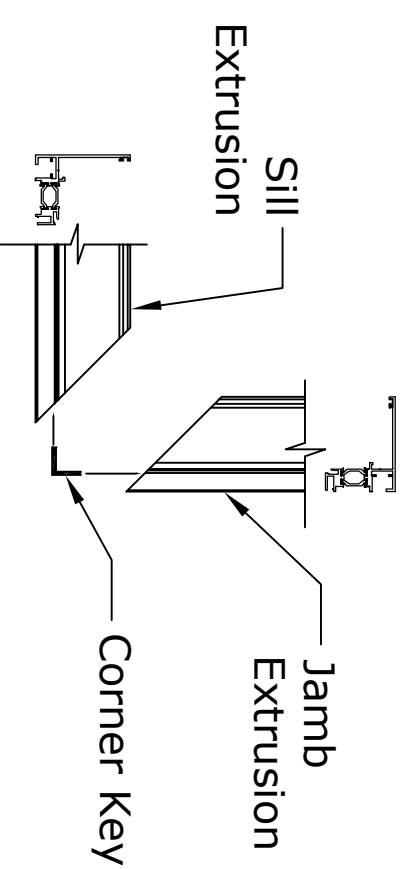

Fig 2A

Solutions in Polycarbonate

6553 Norwalk Road, Medina, Ohio 44256
 Phone 330-572-2860, Fax 330-572-2861

Project Name: ****
Project Location: ****
Customer Name: ****

WindowTherm™
40mm Window Wall System
Installation Instructions

STEP THREE:

- 1.) Prior to starting the installation, mark the sill, jambs and head with chalk lines in from the exterior face of the opening. The dimension will be given on the approved shop/fabrication drawing sent with the product.
- 2.) Starting from one side or the other insert the starter sill and jamb corner section into the opening. See Fig 3. Make sure that the sill and jamb are aligned with the chalk line marks.
- 3.) Install the anchor screws (furnished by SIP) in ALL pre-drilled holes. See Fig 4.

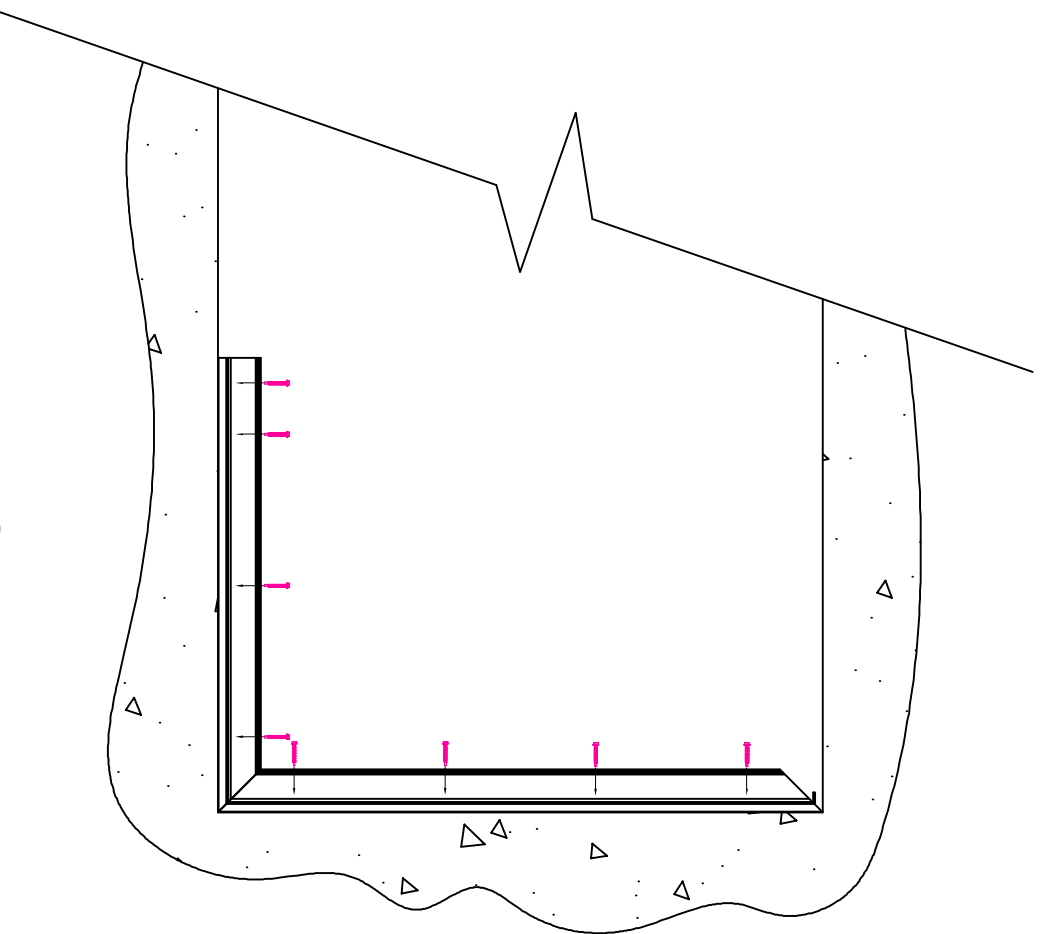

Fig 3

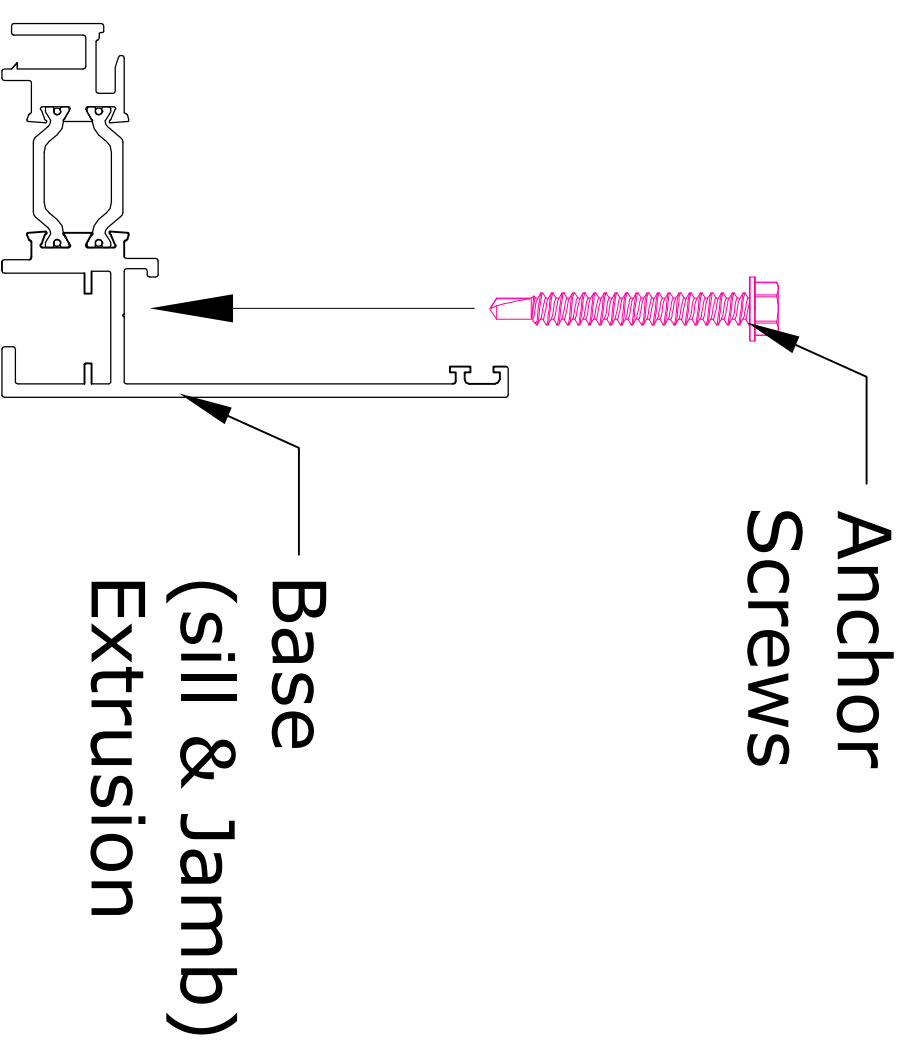

Fig 4

Solutions in Polycarbonate

6553 Norwalk Road, Medina, Ohio 44256
Phone 330-572-2860, Fax 330-572-2861

Project Name: ****

Project Location: ****

Customer Name: ****

WindowThermTM

40mm Window Wall System
Installation Instructions

IS-3

STEP FOUR:

- 1.) Once the sill and jamb are anchored into place install the head base extrusion.
- 2.) Make sure that the head base extrusion is aligned with the chalk lines that we snapped prior.
- 3.) Install the anchor screws (furnished by SIP) in ALL pre-drilled holes as shown in Fig 4 on previous page.
- 4.) Install a splice block 2" into the sill and head base extrusion. This will leave 2" exposed.
- 5.) Install one #10 hex head tek screw through the base extrusion into the splice block to secure it. See Detail "A".
- 6.) Apply silicone sealant (furnished by installer) over entire splice joint and tek screw then tool in for proper adhesion. Make sure that the caulking is applied 2x the depth of the width of the joint. (Example if joint is 1/8" wide the caulk should be applied 1/4" deep)

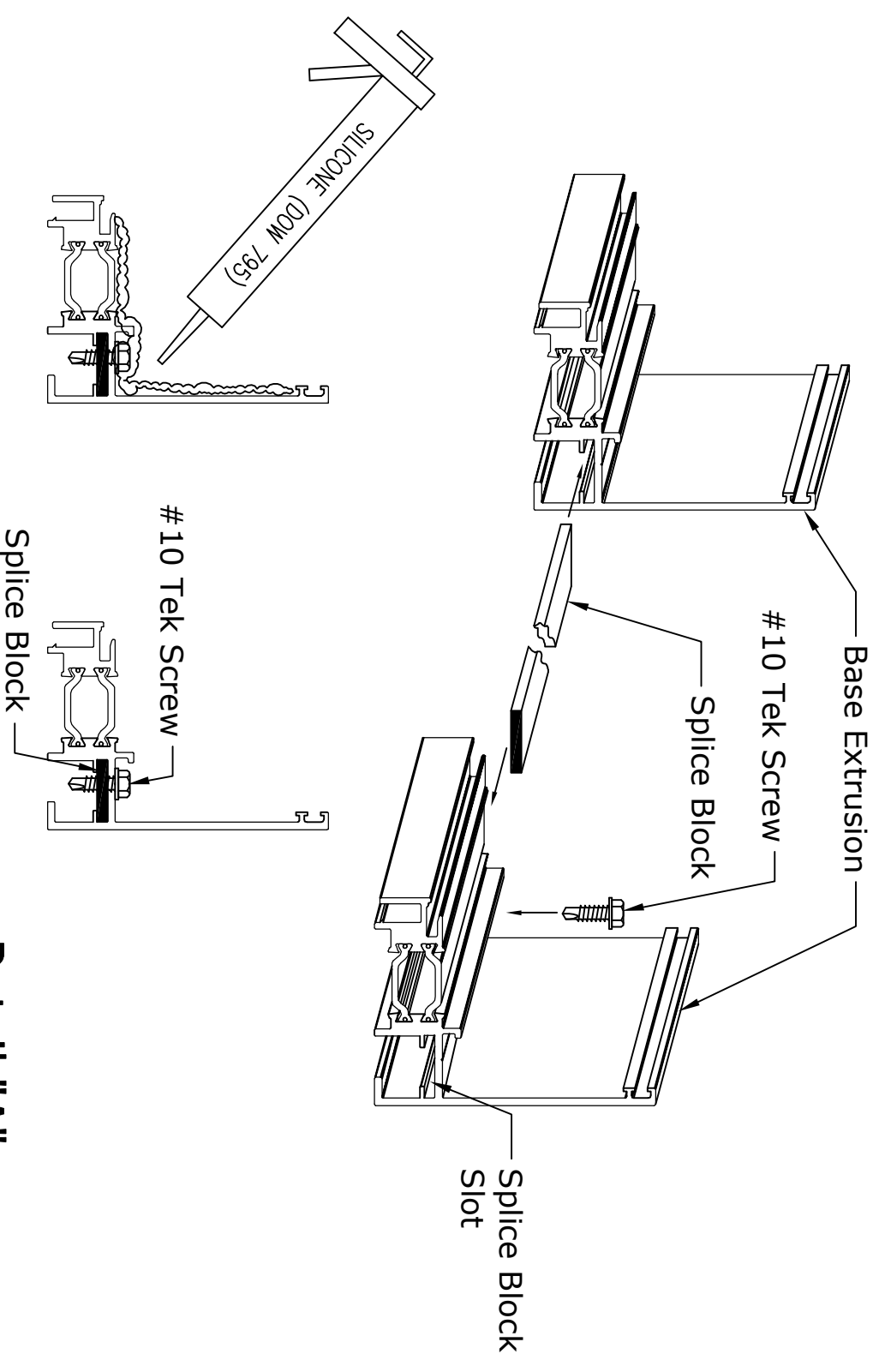
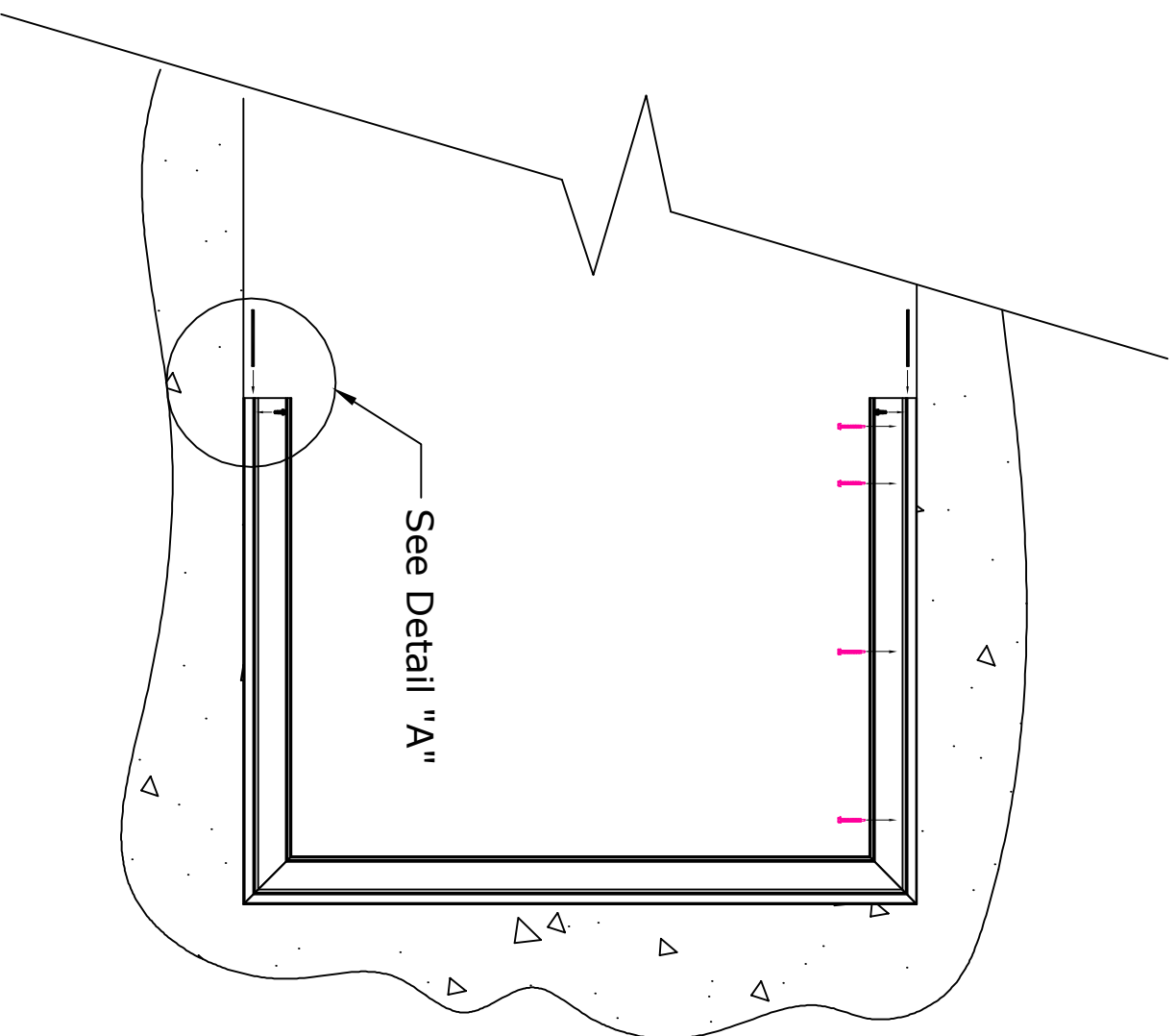

Solutions in Polycarbonate

6553 Norwalk Road, Medina, Ohio 44256
Phone 330-572-2860, Fax 330-572-2861

Project Name: ****

Project Location: ****

Customer Name: ****

WindowTherm™

40mm Window Wall System

Installation Instructions

IS-4

STEP FIVE:

- 1.) After the first sill, jamb and head base extrusions are installed continue installing the sill and head base extrusions.
- 2.) Slide the sill or head base extrusions over exposed splice block. See Fig 5.
- 3.) Make sure to align the base extrusions with the snapped chalk lines.
- 4.) Install the anchor screws (furnished by SIP) into ALL of the pre-drilled holes. See Fig 6.

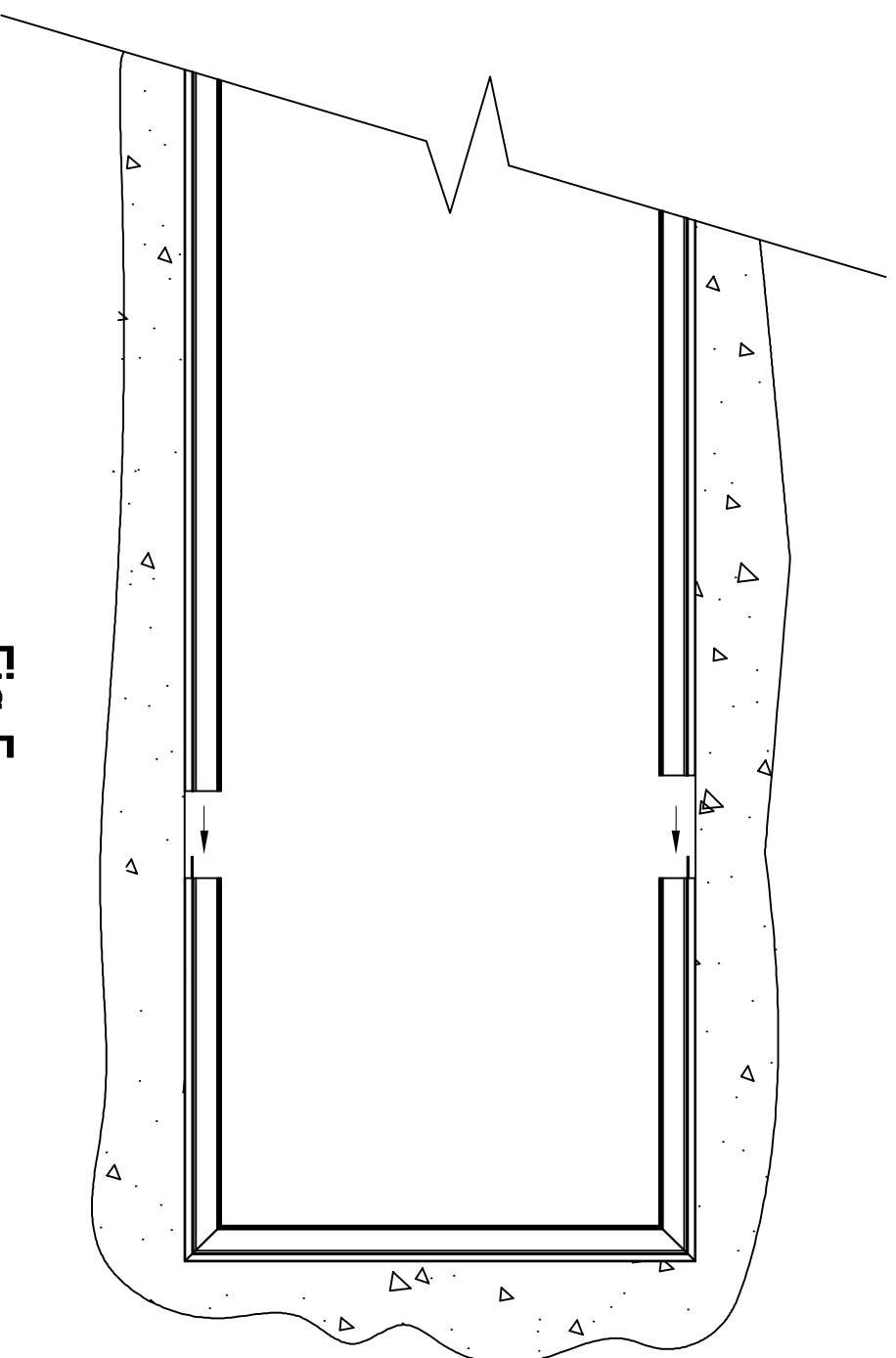

Fig 5

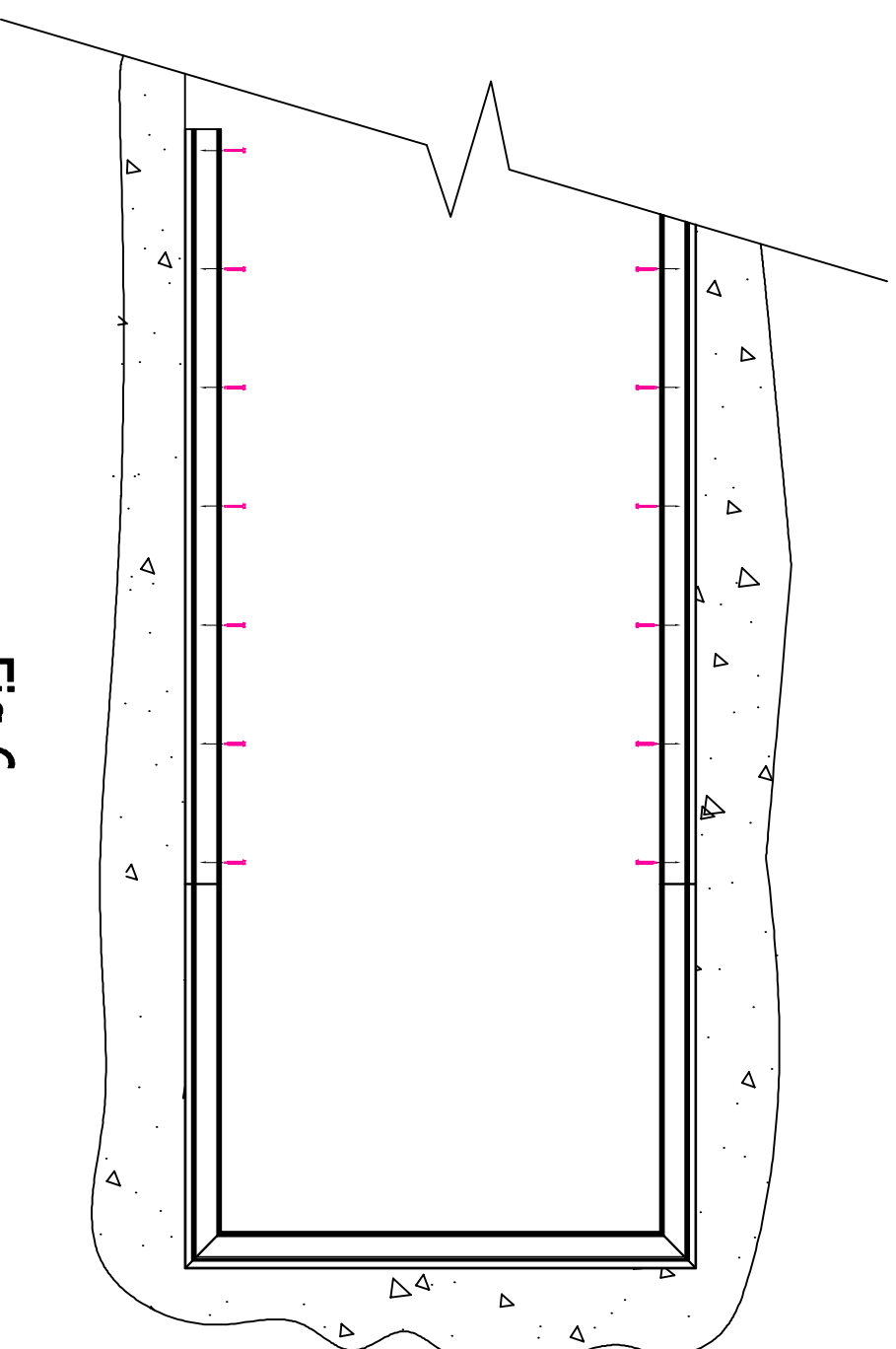

Fig 6

Solutions in Polycarbonate

6553 Norwalk Road, Medina, Ohio 44256
Phone 330-572-2860, Fax 330-572-2861

Project Name: ****

Project Location: ****

Customer Name: ****

WindowTherm™

40mm Window Wall System
Installation Instructions

IS-5

STEP SIX:

- 1.) Remove peel coat film from exterior face of glazing panels if the panels are in direct sunlight during installation. Peel back the film on all four sides on the interior face of panels. This will protect panels from damage during installation. This can be done to exterior face as long as not in direct sunlight. Remove ALL peel coat film once installation is complete.
- 2.) The starter panel will be a full width panel with the tongue removed. See Detail "B" on Page 7.
- 3.) Slide the starter panel into the framing to within 1/4" of the jamb glazing seat. See Fig 7 below and Detail "C" on Page 7.
- 4.) Install the next full panel by snapping the tongue into the starter panel. See Fig 7 below and Detail "D" on Page 7.
- 5.) With both panels in place the next step will be to install the pressure retainer. See Fig 8.
- 6.) Using a non-marring rubber mallet tap the pressure retainer into place. See Detail "E" on Page 7.
- 7.) Continue installing panels by snapping the tongue into the groove and installing pressure retainer as you continue to opposite end.

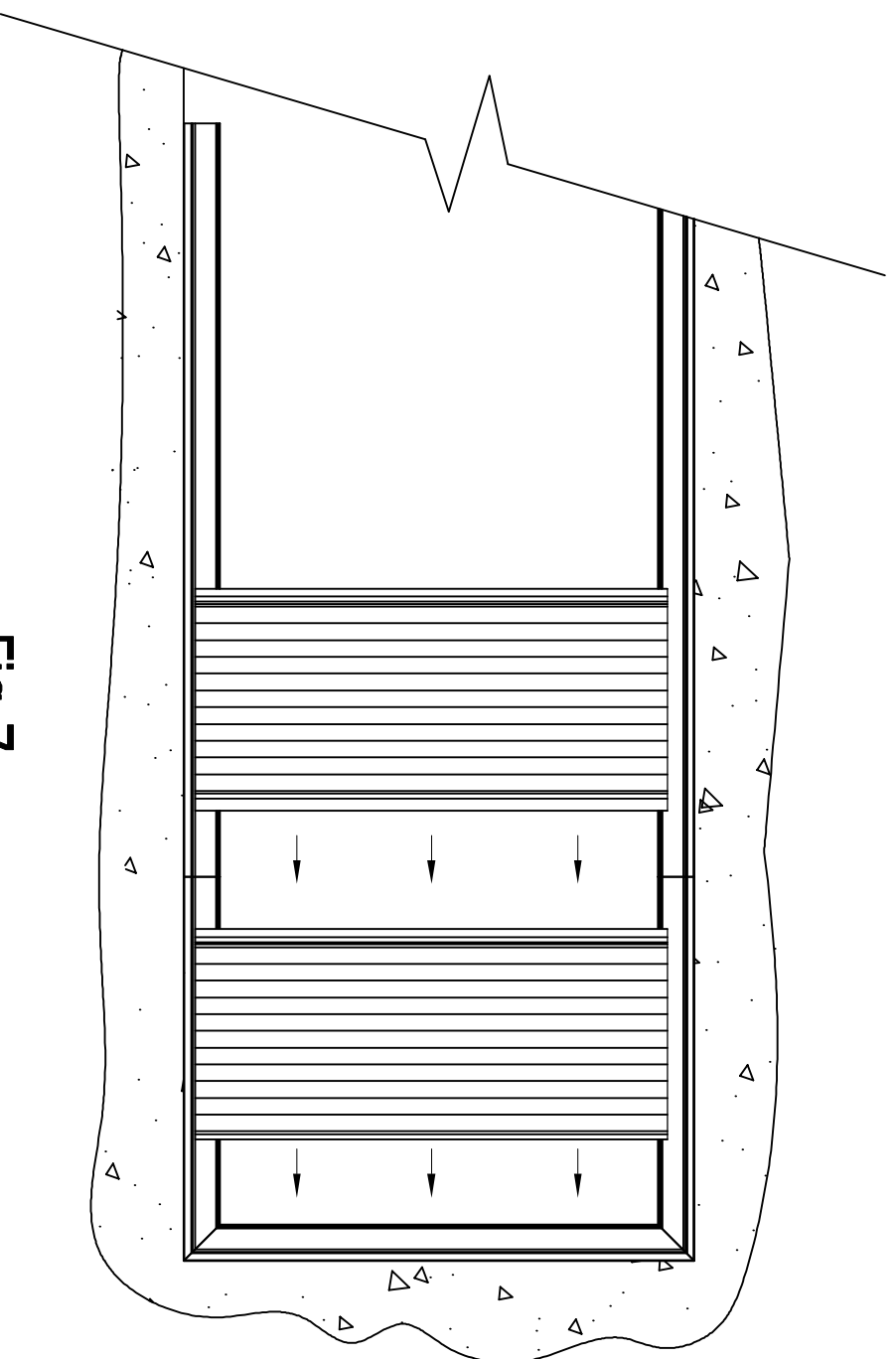

Fig 7

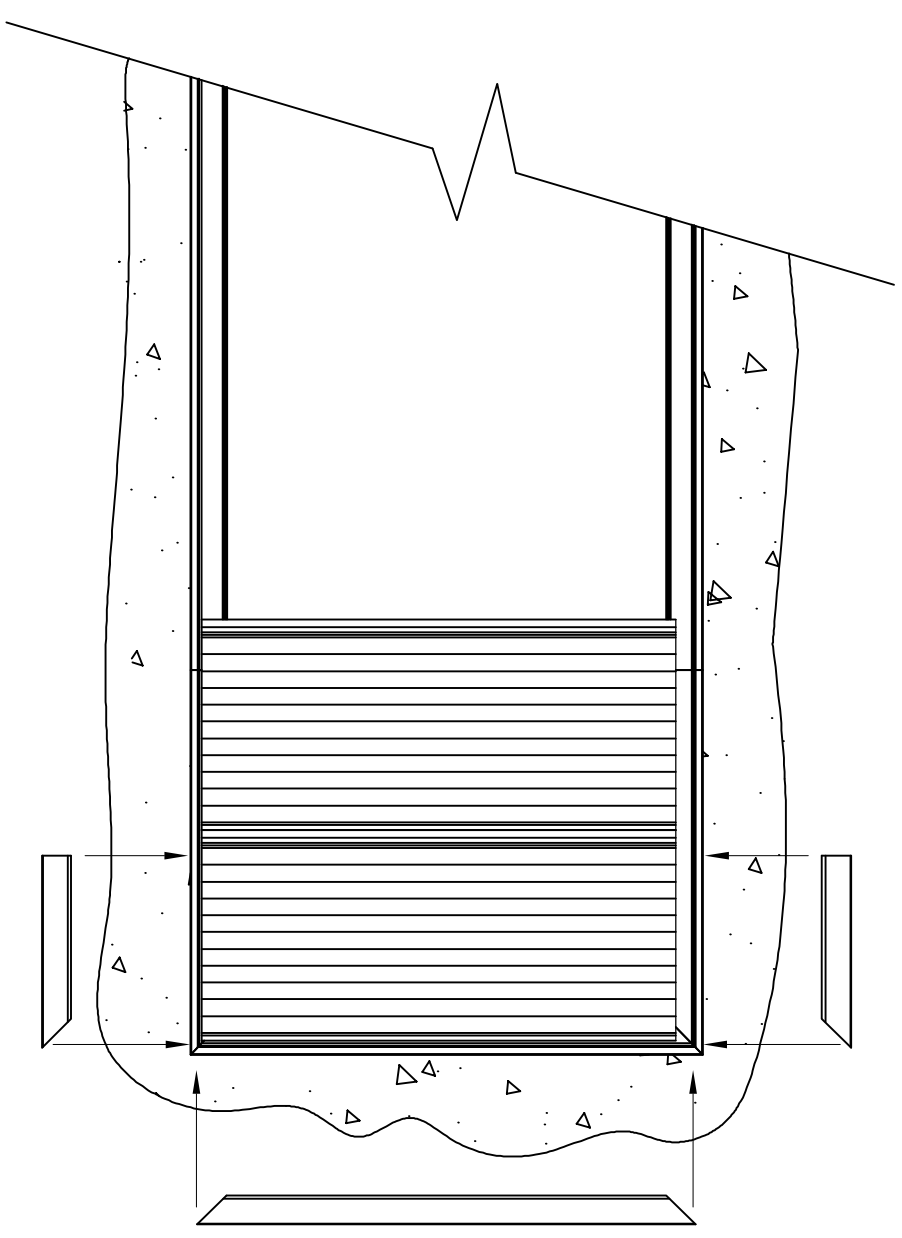

Fig 8

Solutions in Polycarbonate

6553 Norwalk Road, Medina, Ohio 44256
Phone 330-572-2860, Fax 330-572-2861

Project Name: ****

Project Location: ****

Customer Name: ****

WindowThermTM

40mm Window Wall System
Installation Instructions

IS-6

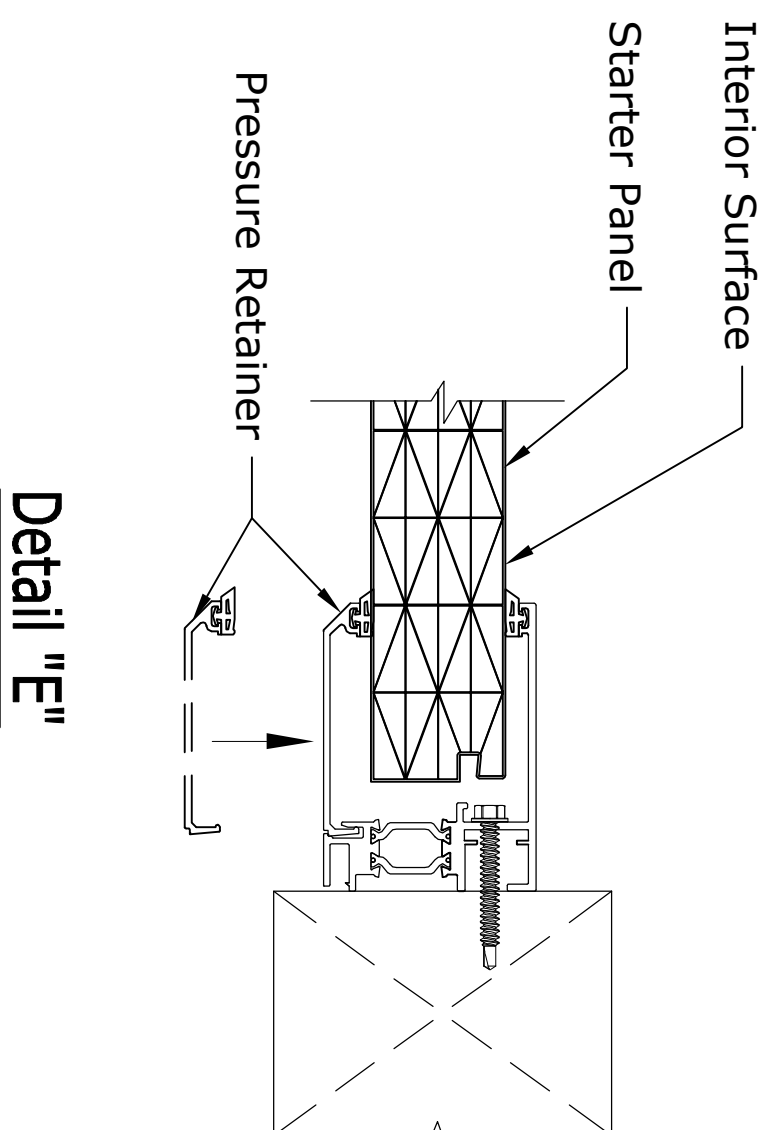
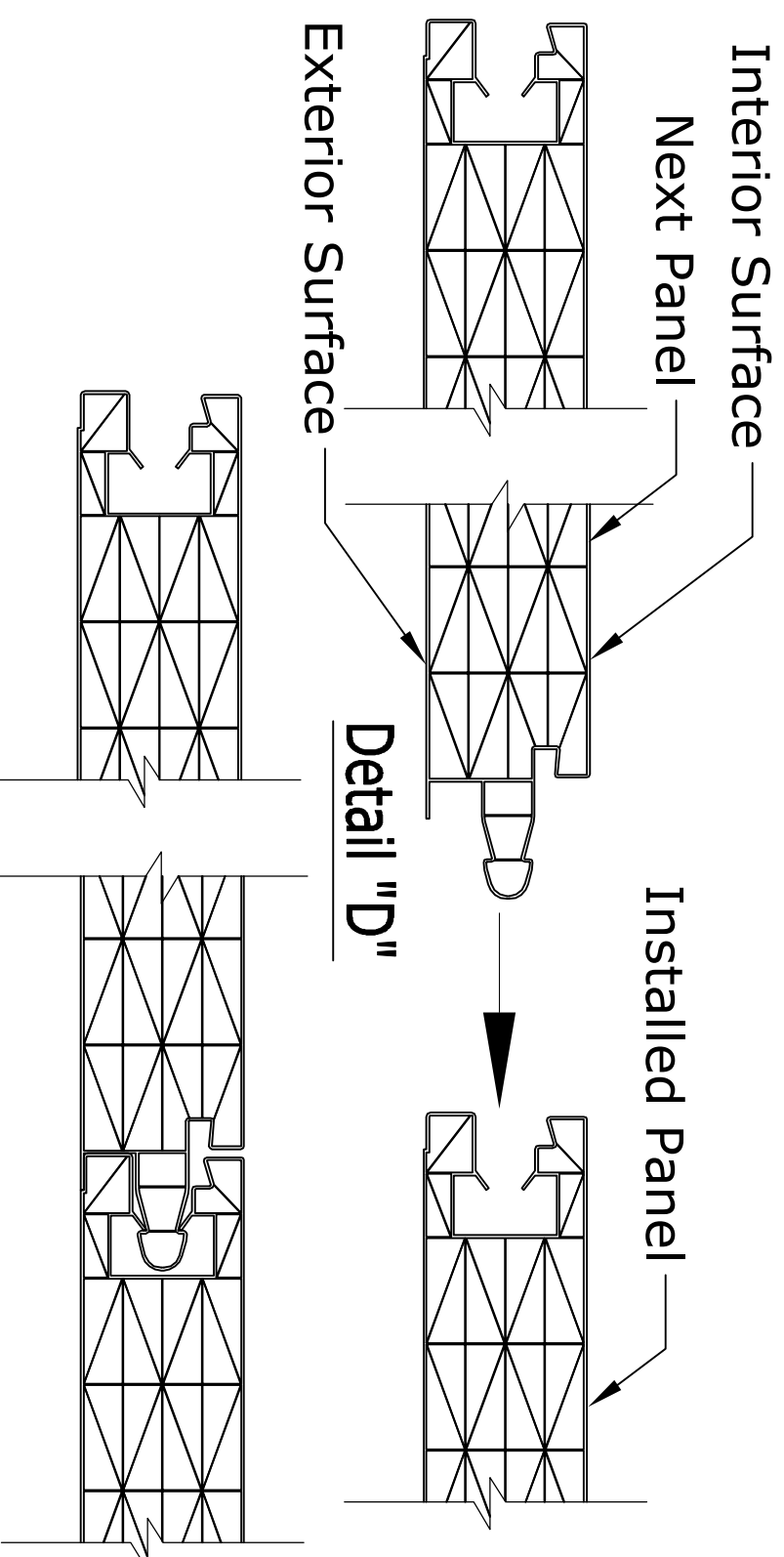
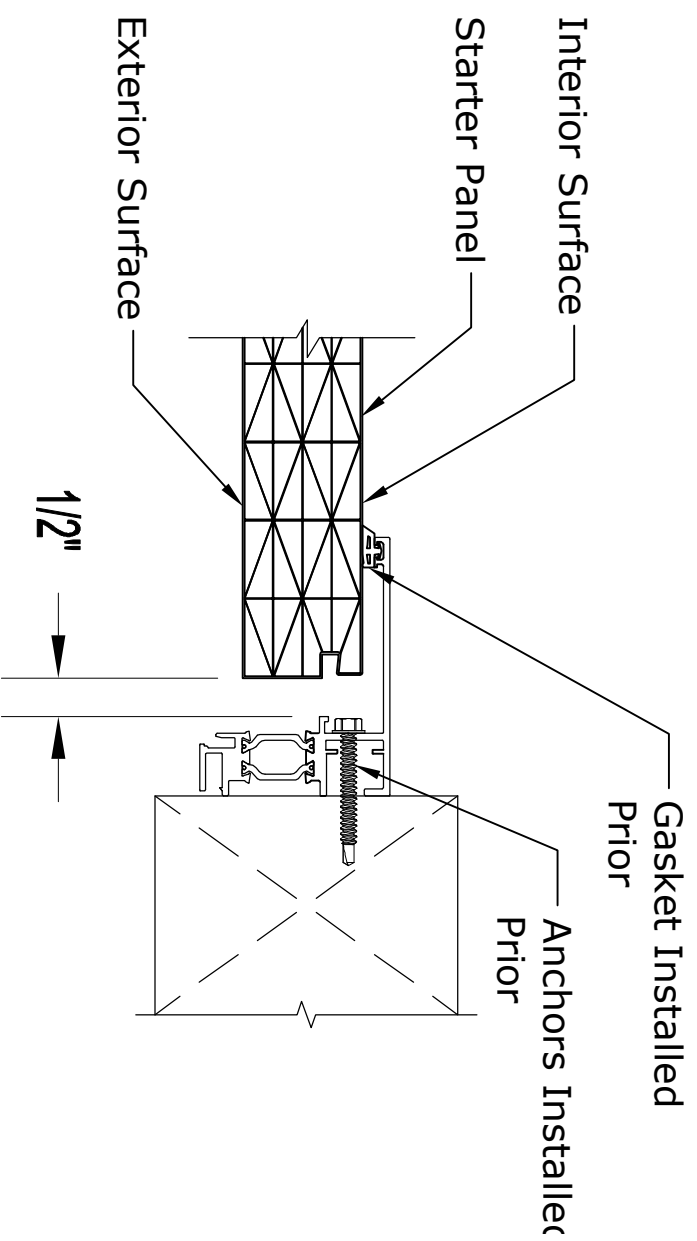
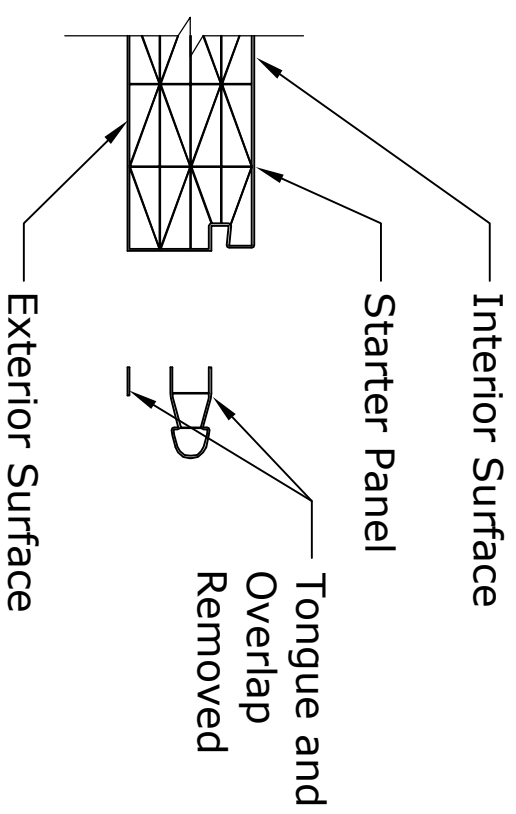

Solutions in Polycarbonate

6553 Norwalk Road, Medina, Ohio 44256
 Phone 330-572-2860, Fax 330-572-2861

Project Name: ****

Project Location: ****

Customer Name: ****

WindowTherm™

40mm Window Wall System

Installation Instructions

STEP SEVEN:

- 1.) When installing that last panel it may be necessary to cut the panel to the correct width. See Fig 9.
- 2.) Measure from the edge of the last panel installed to the glazing seat on the jamb. See Detail "F".
- 3.) With the dimension that you acquired subtract 1/2". This will be the width dimension of the last panel.
- 4.) Measure from the tongue side of the panel at the base of the tongue toward the groove side. See Detail "G".
- 5.) Mark the panel with the dimension and cut the panel at that dimension.
- 6.) Snap the last panel tongue into the groove of the next to last panel. See Fig 9.
- 7.) Using a non-marring rubber mallet tap the pressure retainer into place. See Detail "E" on Page 7.

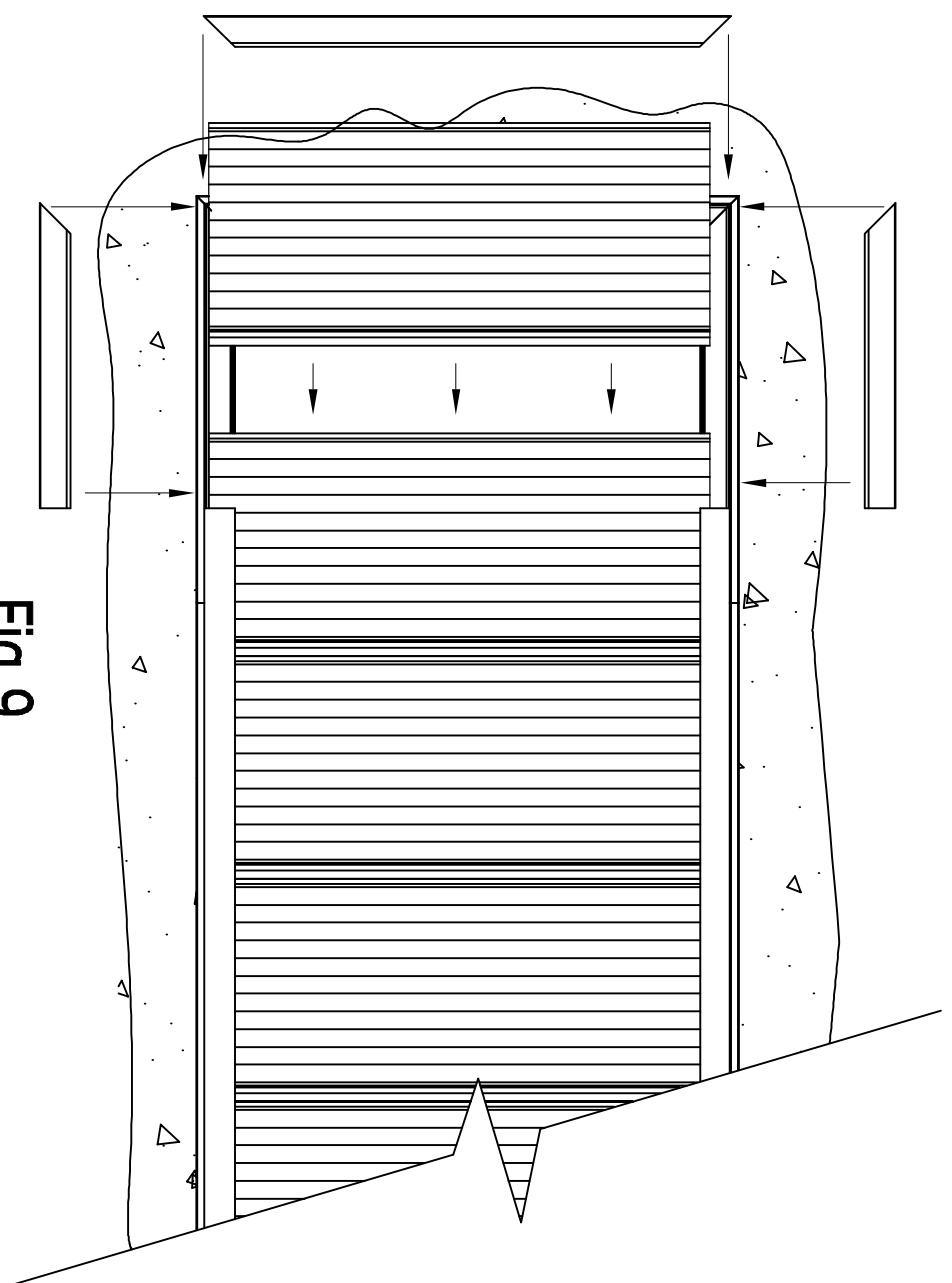
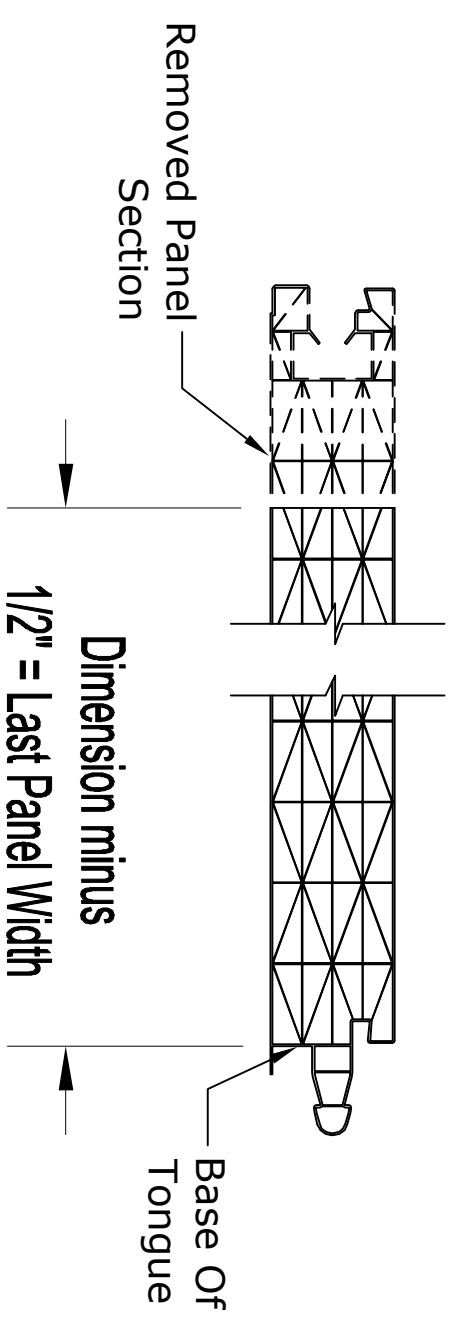
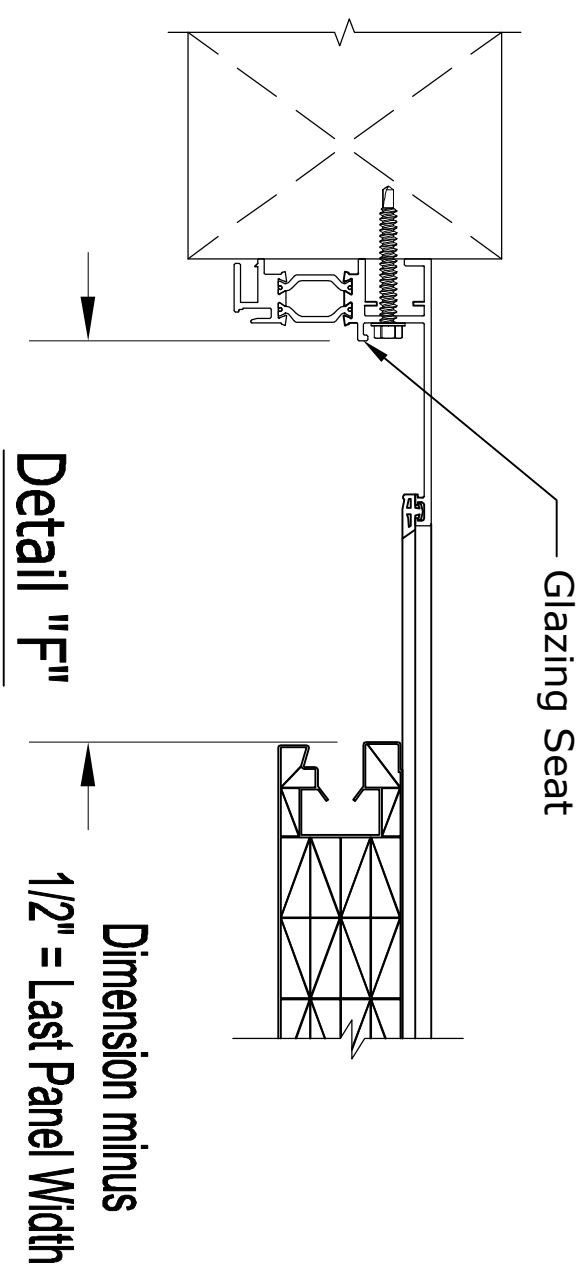

Fig 9



Detail "G"

Solutions in Polycarbonate

6553 Norwalk Road, Medina, Ohio 44256
 Phone 330-572-2860, Fax 330-572-2861

Project Name: ****
Project Location: ****
Customer Name: ****

WindowTherm™
 40mm Window Wall System
 Installation Instructions

STEP EIGHT:

- 1.) Apply a bead of silicone sealant (furnished by installer) around entire perimeter of framing. See Fig 10 and Details "H", "I" and "J". Make sure that the caulking is applies 2x the depth of the width of the joint. (Example if joint is 1/8" wide the caulk should be applied 1/4" deep)
- 2.) After applying the bead of sealant it must be "tooled" in for proper adhesion and aesthetics.
- 3.) The use of masking tape to make a sharp silicone joint is recommended. (masking tape furnished by installer).
- 4.) The installation is now complete.
- 5.) Review the cleaning and maintenance manual for proper care of your new Solution In Polycarbonate LLC, WindowTherm™ Window Wall System.

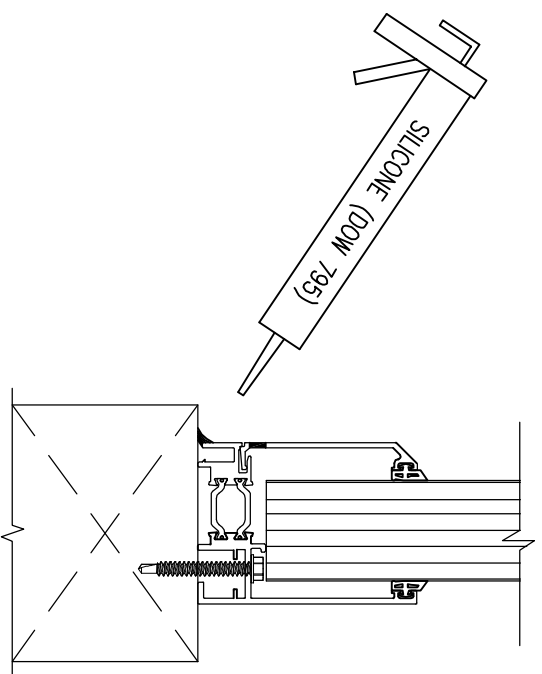

Detail "H"

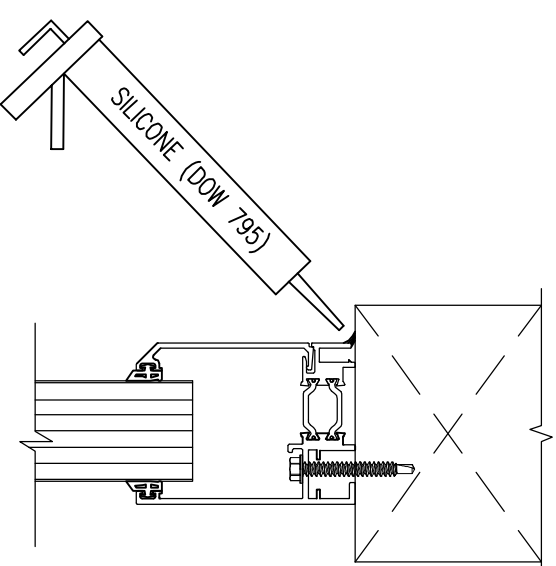

Detail "I"

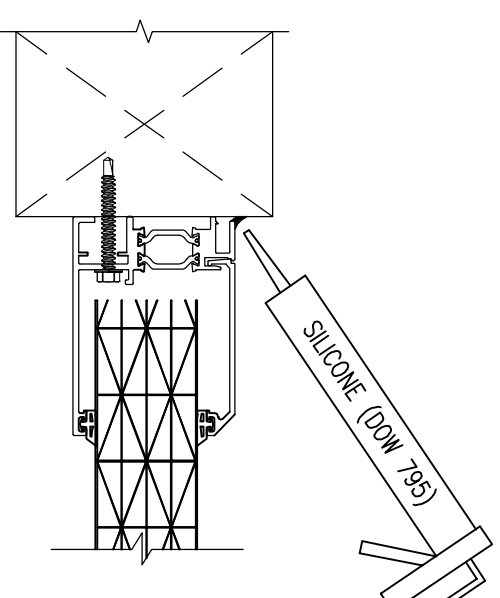

Detail "J"

Fig 10

Solutions in Polycarbonate

6553 Norwalk Road, Medina, Ohio 44256
Phone 330-572-2860, Fax 330-572-2861

Project Name: ****

Project Location: ****

Customer Name: ****

WindowTherm™

40mm Window Wall System

Installation Instructions

IS-9