

# PRODUCT DATA SHEET

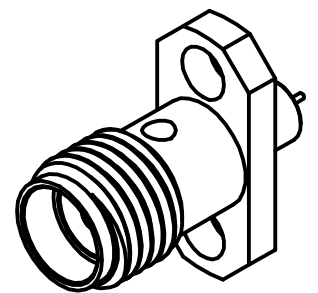
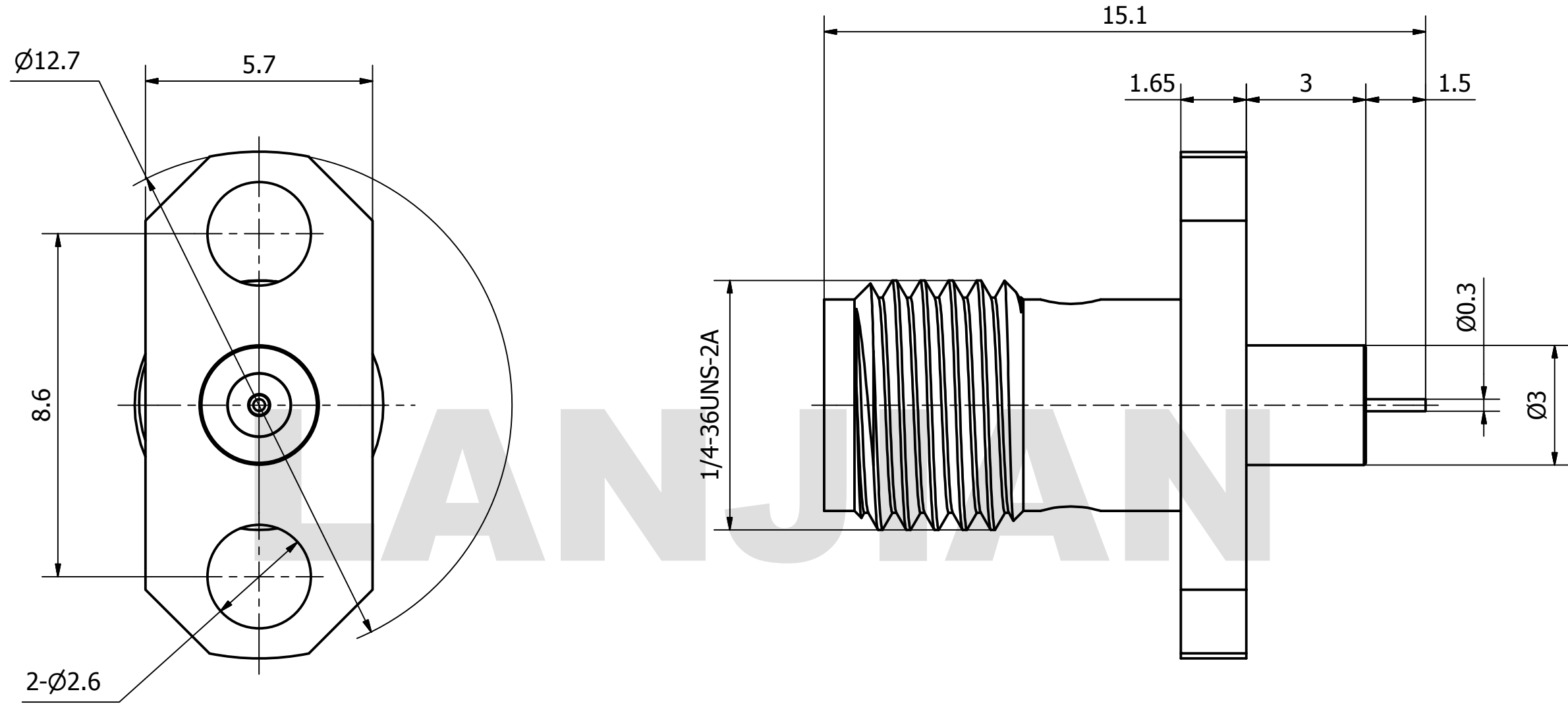

**MATERIAL:**  
 BODY: BRASS  
 CONTACT: BERYLLIUM COPPER PER ASTM B196.  
 ALLOY NO. UNS C17300  
 INSULATOR: PTFE

**PERFORMANCE:**  
 IMPEDANCE: 50 OHMS  
 FREQUENCY: DC TO 6 GHz  
 VSWR:  $\leq 1.15$

THIS DOCUMENT CONTAINS CONFIDENTIAL AND PROPRIETARY INFORMATION THAT CANNOT BE REPRODUCED OR DIVULGED, IN WHOLE OR IN PART, WITHOUT WRITTEN AUTHORIZATION FROM "LANJIAN ELECTRONICS"	MATERIAL :		
	UNLESS OTHERWISE SPECIFIED: DIMENSIONS IN MM		
	TOLERANCES :		
	X.X	$\pm 0.20$	ANGULAR : $\pm 1^\circ$
	X.XX	$\pm 0.10$	FILLETS R/C : $\pm 0.10$
	X.XXX	$\pm 0.01$	SURFACE FINISH : Ra 1.6
			DEBURR AND BREAK SHARP EDGES
		NAME	DATE
	DRAWN	YaoJiang	08/14/2018
	CHK'D	HongZhongYan	08/14/2018
APPV'D	HongZhongYan	08/14/2018	
MFG			
PROJECTION		SIZE	SCALE
		A3	8: 1

**LANJIAN ELECTRONICS**

38 Hengtong Road, Xinqu Dingmao  
 Zhenjiang, 212009, Jiangsu, P. R. China

TITLE

**SMA-KFD2-127030P**  
 jack micro-strip connector

DWG No.	REV.
GCPZ3.660.A.040	A
DO NOT SCALE THE DRAWING	
PAGE 1 / 1	