

70mm Tilt & Turn Window



Features

Frame Offering

- < Dedicated outerframe - 68mm and 83mm height
- < Choice of 3 transom widths - 63mm, 72mm and 86mm
- < Dedicated 65mm sash
- < All sections available featured and bevelled
- < Available fully welded or mechanically jointed.

Weatherseals

- < High performance Q-Lon gasket supplied in all mainframe sections with a manufacturer lifetime guarantee.

Thermal and Steel Reinforcing

- < Galvanised steel range to suit topography requirements
- < Aluminium range for mechanical joint requirements
- < Range of thermal reinforcements (with strip steel) for higher 'U' value and ERP requirements
- < All reinforcements are designed to achieve required security and weathering requirements, where required.

Finishes

- < Standard white and brilliant white
- < Range of solid colour and woodgrain foils.

Glazing

- < Choice of 4 glazing thicknesses - 24mm or 28mm for double glazed units. 36mm or 44mm for triple glazed
- < Astrical, Georgian bars in 20mm and 28mm widths.

Ancillaries

- < Comprehensive range of add-ons, couplers, corner posts, bay poles available to suit any installation.

Hardware

- < Full depth eurogroove positioned centrally, accepts a wide range of perimeter locking and concealed hardware.
- < Secured By Design and Part Q specification available.

Ventilation

- < Proprietary ventilation devices can be used on all designs
- < A range of ventilation options available including large outerframe, head extension and dedicated one piece head vent (see cavity closer for further details).

Thermal Performance

- < A range of A++ to C and 0.8 to 1.6 'U' value performance are achievable with the Duraflex Diamond Suite. See separate energy performance data sheet for details.

Test Results

| Frame Type | Size | Air Permeability | Water Tightness | Wind Resistance | Standard | Accreditation Body |
|---------------------------|-------------|------------------|-----------------|-----------------|---------------|--------------------|
| Tilt & Turn | 1200 x 1200 | 600Pa | 450Pa | 2400Pa | BS6375-1:2004 | BSI |
| Tilt & Turn | 1300 x 2100 | 600Pa | 600Pa | 2400Pa | BS6375-1:2009 | BBA |
| Tilt & Turn next to fixed | 1500 x 2400 | 600Pa | 300Pa | 1200Pa | BS6375-1:2009 | BBA |

70mm Tilt & Turn Window

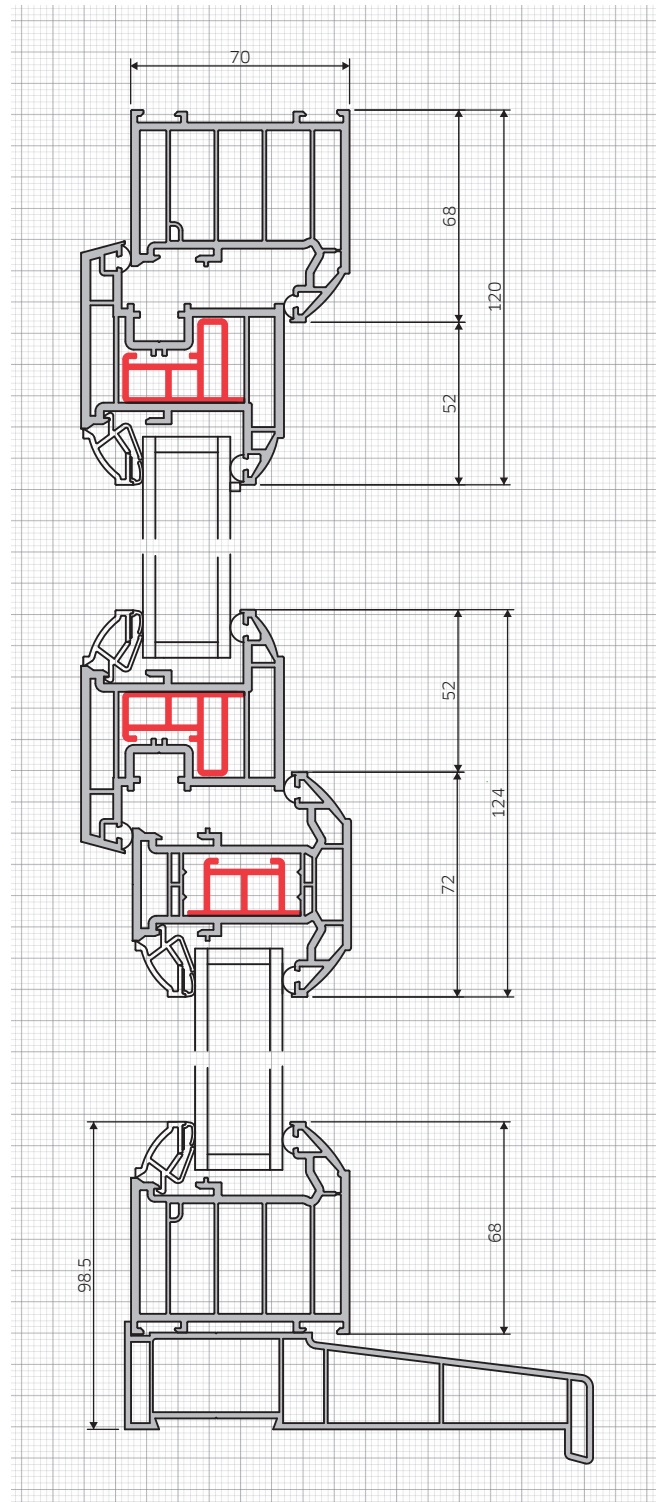

Performance

Security

- < A wide range of hardware options available
- < Concealed and perimeter locking options
- < Enhanced security, Secured By Design hardware also available.

Thermal

- < A large number of simulations have been carried out by 'approved' simulators at Duraflex providing a comprehensive range of WER's (Window Energy Ratings) for A++, A+, A, B and C ratings and 'U' values to 1.4W/m²k using standard readily available components, lower 'U' values are available with the use of special glass combinations.

General Features

- < **Q-Lon** - 99% compression recovery, high performance acoustic and weathersealing properties with lifetime guarantee. Operates perfectly in temperatures ranging from -20°C to 70°C
- < **Lead Free** - environmentally friendly, calcium organic lead free formulation
- < **Finishes** - comprehensive range of natural wood and solid colour foils
- < **Structural** - comprehensive range of coupling sections to suit various applications.