

OHIO HISTORIC INVENTORY

Ohio Historic Preservation Office
1985 Veina Avenue
Columbus, Ohio 43211
614-466-1500

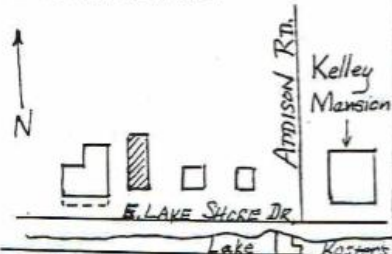

No. ERI-1643		4. Present Name(s) "The Bowling Alley"		1. No. ERI-1643
5. Other Name(s) ERIE		Location of Negatives O.H.S.		
Specific Location N. side of E. Lake Shore Dr east of Himmelein House & 3th house east of Division St		16. Thematic Category Ethnic, Commercial, Recreation		2. County ERIE
City or Town, If Rural, Township & Vicinity Kelleys Island		17. Date(s) or Period 1886		
Site Plan with North Arrow 		18. Style or Design Vernacular		4. Present Name(s) "The Bowling Alley"
19. Architect or Engineer -		28. No. of Stories 1		
20. Contractor or Builder Ralph Dwelle (Remodeller)		29. Basement? Yes <input type="checkbox"/> No <input checked="" type="checkbox"/>		
21. Original Use, if apparent Bowling Alley		30. Foundation Material Limestn Rubl Pilin		
22. Present Use Residence		31. Wall Construction Wood frame		
23. Ownership Public <input type="checkbox"/> Private <input checked="" type="checkbox"/>		32. Roof Type & Material Gable/ashp shingle		
24. Owner's Name & Address, if known F. William Pape Box 421, Kelleys Island, O		33. No. of Bays Front 3 Side 1		
25. Open to Public? Yes <input type="checkbox"/> No <input checked="" type="checkbox"/>		34. Wall Treatment Board & Batten		
26. Local Contact Person or Organization Kevin Pape: KI Hist Survey		35. Plan Shape Rec.		
27. Other Surveys in Which Included N/A		36. Changes (Explain in #42) Addition <input type="checkbox"/> Altered <input type="checkbox"/> Moved <input type="checkbox"/>		
28. J.T.M. Reference 7 3 5 7 6 8 0 4 6 0 5 8 5 0		37. Condition Interior Good Exterior Good		
29. Easting Northing Site Building <input checked="" type="checkbox"/> Structure Object <input type="checkbox"/>		38. Preservation Underway? Yes <input checked="" type="checkbox"/> No <input type="checkbox"/>		
30. Original Register? Yes <input checked="" type="checkbox"/> No <input type="checkbox"/> 12. Is it Eligible? Yes <input checked="" type="checkbox"/> No <input type="checkbox"/>		39. Endangered? By What? Yes <input type="checkbox"/> No <input checked="" type="checkbox"/>		
31. Part of Estab. Hist. Dist.? Yes <input checked="" type="checkbox"/> No <input type="checkbox"/> 14. District Potent'l? Yes <input checked="" type="checkbox"/> No <input type="checkbox"/>		40. Visible from Public Road? Yes <input checked="" type="checkbox"/> No <input type="checkbox"/>		
Name of Established District K.I. Lake Shore District		41. Distance from and Frontage on Road 25'; 40'		
Further Description of Important Features (Continue on reverse if necessary)				5. Other Name(s)
Photo				
History and Significance This cottage was originally a bowling alley of two lanes, with a two story saloon to the front, and was an auxiliary building for the Himmelein Hotel immediately to the west. This hotel (ERI-1642) had been established by Johann and Johanna Himmelein on land purchased from Alfred S. Kelley c.1859. Beginning as a modest four room establishment, it was enlarged several times				
Description of Environment and Outbuildings As do other homes on this block, the cottage sits well back from the road on level, well tended lawns on a slight bluff above the lake shore. A few of the large white poplars that once formed a grove in front of the hotel are still standing. A shared drive runs between the two buildings. The				
Sources of Information 1. Rich, History of Erie Co., Oh., 1880 2. Samson Insurance Map, 1886, 1905 3. P.W.R. 8/19/1885 4. Erie Co. Grand List: 1867, 1887; Deed Vol. 161, Pg. 533 5. Hamilton Collection, Hayes Pres. Center; P.W. Pape				46. Prepared by B. Pape & K. Pape
				47. Organization KI Planning Commiss
				48. Date: 149. Revision Date(s)

House Type No. _____

Code No. _____ Name _____

Historic Outbuildings and Dependencies

Barn Type(s)

Code No. _____ Type _____

Corn Crib or Shed Smoke House Privy
 Silo Spring House Cabbage House
 Summer Kitchen or Ice House

Other _____

Archaeological Site on Property?

Yes
 No

Basis for Information

Owner Collection
 Above Ground Earthworks or Mound
 Cultural Materials Noted OAI No. _____

53. Farmstead Plan

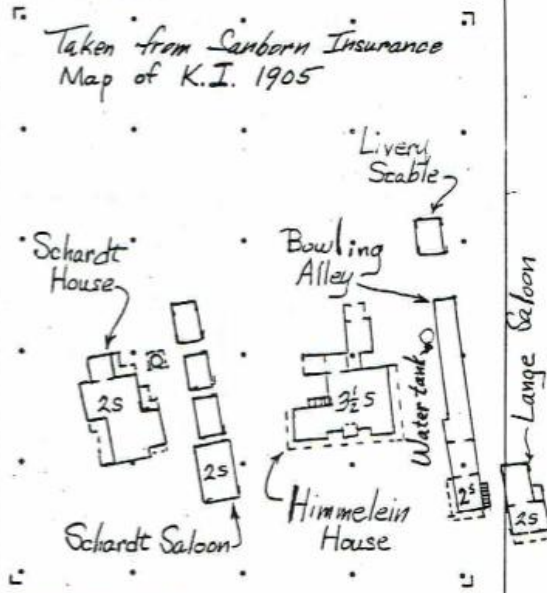

54. Photo

Roll No. _____ Picture No(s) _____

(Cont'd)

53. (Cont'd.)

Over the years to accommodate the island's growing tourist trade. In 1874 a two story saloon building with living accommodations on 2nd was built on the grounds to the east, and in 1886 the bowling alley (or skittles alley as it was then known) was added a few feet north of the tavern. This addition included a billiards room as well. According to the 1880 Nichols Guide to Put-in-Bay, Bass Islands and Kelleys Island, it was a place where "one could partake of billiards, skittles and fine cigars". One source recalls that there was a separate room for ladies in the rear of the saloon; another, that John Hughes (ERI-1576) tended bar here. These latter points have not been confirmed. In the late 1880's and early 1900's the Himmelein Hotel complex was flanked on the west by Schardt's Hotel and Bar (not extant), & on the east by Lang's saloon (see ERI-1644), making this area one of the chief centers for tourist trade and recreation.

After the Himmelein Hotel ceased operation, Richard Himmelein, son of Johann, converted the bowling alley to a summer residence in partnership with a friend, Fritz W. Pape. The two story saloon was razed and a new entrance porch added to the S. end of the alley. The only other exterior change occurred in 1943 when a 30 foot section of the alley was removed at the rear.

(Cont'd.) The water tank which stood to the rear of the building's west side, and the small horse barn located 25-30' to the back are now gone.