



**HYDRAULIC AUGERMATE PUMP SYSTEMS**



PART #	DESCRIPTION	PRICE EA.
H485BI	8HP BRIGGS RECOIL START (1900 PSI@6.5GPM.)	\$ 2095 SALE
H485BESI	8HP BRIGGS KEY START (1900 PSI@6.5GPM.)	\$ 2375 SALE
H485BESH	8HP HONDA KEY START (1900 PSI@6.5GPM.)	\$ 2420 SALE



**REPLACEMENT PARTS FOR KINZE BRUSH METERS**

PART #	#	DESCRIPTION	PRICE EA.
GA6184	6	48 CELL SOYBEAN DISC	\$ 14.95
GA5794	1	60 CELL SOYBEAN DISC	\$ 14.95
GD11122	2	UPPER BRUSH RETAINER	CALL FOR PRICE
GA5699	3	UPPER BLUE BRUSH	\$ 5.95 SALE
GD8778	4	WEAR STRIP	\$ 11.50 SALE
GA5834	5	LOWER BLACK BRUSH	\$ 13.50
G7536X	7	COMPLETE BRUSH METER LESS DISC	\$ 143



1



7



2



3



4



5



6

**Precision Planting® vSet®**



Every 1% Loss in Singulation Costs You up to 2.5 Bu/A\*

Meter performance is a key contributor to yield. If your meters perform at less than 99% singulation, you are losing out on yield. Walk your fields and measure off 17' 5" of one of your 30" rows. Is there one skip? Is there a double? Are there more? Can you afford that at today's grain prices? Every Seed Counts

Planting refuge corn mixed in with your traits? Using high-rate seed treatments or inoculants? Seed not consistently graded? Successfully singulating seed is getting harder. Not all meters can handle these inconsistencies in seed shape, size, and density. How well is your meter performing today?

**Get 99%+ Singulation in Corn with vSet**

vSet uses a high vacuum setting and an aggressive singulator to properly singulate seeds across a variety of sizes and shapes. There is no need to change the disk, the singulator settings, or the vacuum level. By the time the disk passes the singulator, one seed is ready to drop down the tube. Every time. Just pour in the seed and plant.

Please Call For Availability.  
PRICES SUBJECT TO CHANGE WITHOUT NOTICE!

# Precision Meter

Improve planter performance where it counts – in the meter.

Ordinary finger meters have a hard time singulating, especially with a wide variety of seeds. They'll miss one, then grab two, resulting in skips and doubles. That not only wastes seeds, it cuts your yield.

Because the components all mesh perfectly, Precision Meters hold one seed at a time, then release it. They're engineered and built to do it again and again. You'll see fewer skips and doubles – and higher yield.

If you don't need a whole new meter, you can still improve your spacing with Precision Meter belts, backing plates or finger sets. We are a Premier Precision Planting dealer and can test your meters and recommend upgrades.



WE CAN TEST MANY  
POPULAR BRANDS OF  
METERS INCLUDING:  
JD  
KINZE  
WHITE  
GREAT PLAINS  
AND MORE...

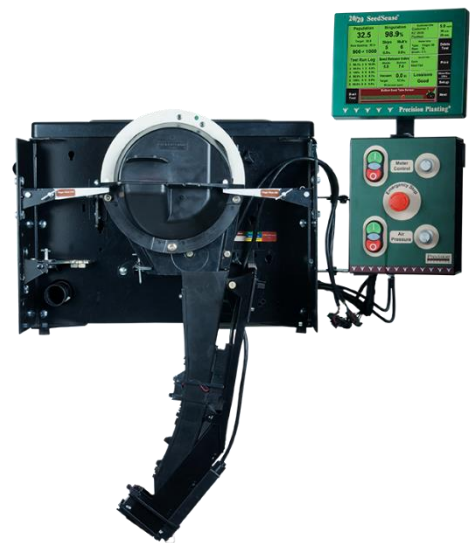

**A WORD FROM THE METER ROOM**

Since 2009 we have done our very best to ensure top quality meter performance on over 10,000 meters.

Our MeterMax Ultra test stand gives the most precise information of any test stand on the market.

With this Knowledge we can determine how accurate your meters are performing. If improvements are needed, we can repair and calibrate them using top quality parts.

Bring in a meter today for a free evaluation. We can develop a plan on how to improve your meters performance for any size operation or budget.

**\*Suggested meter evaluation @ 100-125 acres per row.**  
**\*Replace finger meter brush @ 50 acres per row.**



# Precision Meter

Precision Meters are engineered and built to do it again and again. Ordinary finger meters have a hard time doing that (singulating), especially with a wide variety of seeds. They'll miss one, then grab two, resulting in skips and doubles. That wastes seeds, robs yield and steals your money.

The key features of the Precision Meter are;

- Adjustable Brush**...allows fine tuning for different seed sizes and shapes.
- Precision Finger Set**...loads and holds a single seed due to tougher spring and properly formed flag.
- Population Max** backing plate...rigid so to stabilize the fingers.
- Skip Stop**...cushioning prevents the seed from ricocheting back into the seed pool.
- Sure Fire**...seed belt delivers the seed down the center of the tube increasing excellent seed spacing.

✓ Precision Planting

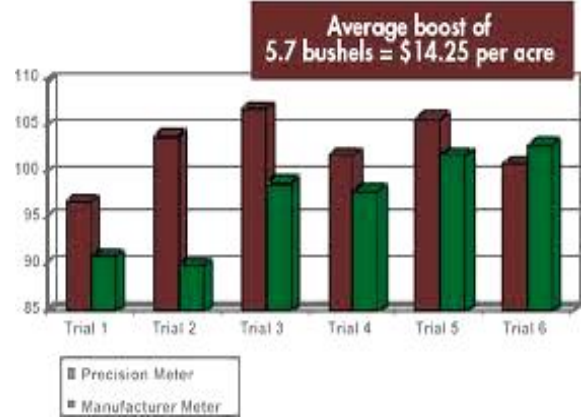

PART #	DESCRIPTION	PRICE	PRICE W/ TUBE
343022	7000 / EARLY KINZE	\$ 230 SALE	\$ 240 SALE
343030	KINZE 3000 SERIES	\$ 230 SALE	\$ 240 SALE
343025	JOHN DEERE 7200-1700	\$ 230 SALE	\$ 240 SALE



343022



343024



343030



**BULLSEYE SEED TUBE**  
 -Reduces Seed Ricochet  
 -TUNGSTEN WEAR PINS  
 -NO SENSOR INTERFERENCE



**\$ 17.50 EA. SALE**

## METER REPLACEMENT PARTS

PART #	DESCRIPTION	PRICE
343052	METER BRUSH (ADJUSTABLE)	\$ 11.00 SALE
342110	"A" INSERT	\$ 10.00 SALE
342103	POP MAX BACKING PLATE	\$ 50.00 SALE
343029	FINGER SET	\$ 60.00 SALE
343066	SURE FIRE BELT	\$ 15.00 SALE
343024	SKIP STOP BACKING PLATE KIT	\$ 30.00 SALE
343014	SKIP STOP CUSHION	\$ 17.00 SALE



343110



343066



343029



343014



343024



Please Call For Availability.  
PRICES SUBJECT TO CHANGE WITHOUT NOTICE!

The eSet meter:

- best-in-class singulation
- outstanding reliability
- easy to maintain
- easy to use

Precision Planting®  
eSet®



Selecting the eSet meter is a no-brainer. It has a flat disk with a single vac setting, eliminating constant adjustments. It releases seeds down the center of the tube – critical to optimum spacing. It has a 5-lobed singulator that makes sure no two seeds of any kind can occupy the same hole. One seed locks in and one seed drops. Every time.

eSet is a star of simplicity. It handles any seed size or shape without finicky tweaks to vac pressure, disk or singulator settings. Just pour in the seed and go. Then get ready for your best possible yield.

A simple replacement for OEM vacuum disks on John Deere planters. You get the disk, baffle, singulator, brushes and seed extractor. Everything mounts to your existing meter housing (1991 or later).



PART #	TYPE	PRICE EA. KIT	PRICE EA. KIT W/ TUBE
720370	STANDARD	\$ 150 SALE	\$ 168 SALE
720136	PRO SERIES	\$ 150 SALE	\$ 168 SALE
720185	EXTRACTOR	\$ 6.50 SALE	-----
720372	SINGULATOR	\$ 51 SALE	-----
720003	SEED DISC	\$ 50 SALE	-----
720076	LID SEAL	\$ 16 SALE	-----
720384	ESET BRUSH SET	\$ 7.50 SALE	-----



COVER CROP SEED DISCS FOR PLANTERS

PART #	MODEL	SEED TYPE AND POP RANGE	PRICE EA.
PLJD-AA0030L	JD VAC METER	LARGE CELL (WHEAT, OATS, CEREAL RYE) 9-35K SEED PER POUND	\$ 46 SALE
PLJD-AA0036S	JD VAC METER	SMALL CELL (RADISH, RAPE SEED, CRIMSON AND CLOVER, RYE) 35-300K SEEDS PER #	\$ 46 SALE
PLKZ-AA0001A	KINZE BRUSH	BLUE DISC 18-2200 SEEDS PER #/ BLACK DISC 200-6000 SEEDS PER #	\$ 37 SALE



Standard VAC/ FINGER Meter Replacement Parts



PART #	MODEL	DESCRIPTION	PRICE EA.
G57258	JD 92+	VAC CHAMBER DOOR FOR SCREW TYPE KNOCK OUT WHEEL	\$ 23.50
G37348	JD 92+	CORN KNOCK OUT WHEEL FOR PRO MAX 40	\$ 12.95
G37076	JD 92+	SCRAPER FOR SOYBEAN AND PRO MAX DISC	\$ 8.95
G57258	JD 75 SER+	VAC CHAMBER DOOR FOR QUICK CHANGE KNOCK OUT WHEEL	\$ 21.00
G81736	JD 75 SER+	QUICK CHANGE KNOCK OUT WHEEL FOR CORN PROMAX 40	\$ 14.50
G79993	JD 75 SER+	SCRAPER FOR QUICK CHANGE VAC DOOR	\$ 8.00
A44990-A	ALL	RUBBER CHAMBER DOOR LATCH	\$ 8.25
P38393-K	ALL	FLEX DRIVE COUPLER FOR SEED METER	\$ 26.00 SALE
343098	JD 7000 KZ 2000	FINGER METER BOX ADAPTER COVER	\$ 12.00
343034	JD 7200 +	FINGER METER BOX ADAPTER COVER	\$ 13.00
343033	KZ 3000 +	FINGER METER BOX ADAPTER COVER	\$ 12.00
343049	JD	FINGER METER BRUSH MAROON	\$ 5.50
KD2020	KINZE	FINGER METER BRUSH BLUE	\$ 3.75

## SEED FLOW LUBRICANTS AND GRAPHITE

- Maximizes yield and profit by increasing plant population per acre.
- Easiest, most economical way to apply seed flow lubricant. No buildup.
- Reduces wear on planter plates.

### MANUFACTURES SUGGESTED USE RATES.

**GRAPHITE:**  
 CORN- 1 Tablespoon Per 80,000CT.  
 SOYBEANS- 1 TBSP. PER 130,000 CT.

**TALC:**  
 CORN- 2.5 Oz's Per 80,000 Ct.  
 SOYBEANS- 2.5 Oz's Per 130,000

**50/50 MIX:**  
 CORN- 2 Oz per 80,000 ct.  
 SOYBEANS- 2 Oz. Per 130,000 ct.

**80/20 MIX:**  
 CORN- ¼ cup Per 80,000 ct.  
 SOYBEANS- ¼ cup Per 130,000 ct.



PART #	TYPE	SIZE (BAG COVERAGE)	USED ON	PRICE EA.
EZ19000	Talc	8 # Jug (52 BAGS)	JD/GP	\$ 22.50 SALE
174-PT30P	Talc	30 # Bucket (192 BAGS)	JD/GP	\$ 59.50 SALE
EZS 9950-3	Graphite	1# Bottle (32 BAGS)	FINGER / KZ BRUSH METER	\$ 6.05 SALE
EZD 9950-0	Graphite	5# Jug (160 BAGS)	FINGER / KZ BRUSH METER	\$ 19.95 SALE
941-99608	Graphite	8# Jug (255 bags)	FINGER / KZ BRUSH METER	\$ 26.95 SALE
AS09058	50/50 Mix	8# Jug (64 BAGS)	CNH Factory Vac	\$ 37.95 SALE
941-09055	50/50 Mix	30 # BUCKET (320 BAGS)	CNH Factory Vac	\$ 71.95 SALE
PP80208	80/20 Mix E-FLOW	8 # Jug (160 BAGS)	JD VAC / PP	\$ 26.50 SALE
RM-09011	80/20 MIX	20# BUCKET (400 BAGS)	JD VAC/ PP	\$ 59.75 SALE
941-09013	80/20 MIX	30# BUCKET (600 BAGS)	JD VAC/ PP	\$ 69.50 SALE
EZRM- 0901	80/20 Mix	40 # Box (800 BAGS)	JD VAC / PP	\$ 65.95 Best Value!
GLID-8	GLIDUALATOR	FITS 8 # JUG		\$ 12.95 SALE



## “PRO CHUTE” BULK SEED BOX CHUTE

Empty your seed boxes directly into your planter. Seed flows smoothly and quickly when you attach the PRO Chute to your bulk seed box. The funnel system is made of UHMW for durability, wear resistance, and slick properties. In as little as four minutes you can empty your seed box with the PRO Chute II. Quick attach for safe unloading. Our PRO Chute snaps into your seed box in under five seconds, without looking underneath to line up brackets. Never stand underneath a raised box again. There is a full 79" of clearance from the lift to the end of the PRO Chute giving you maximum clearance. Slide Gate controls the seed flow.

7.5" x 62" PRO CHUTE I  
 10.5" X 62" PRO CHUTE II

**\$ 525.00 SALE EACH**



Please Call For Availability.  
 PRICES SUBJECT TO CHANGE WITHOUT NOTICE!



# NO-TILL COULTER BLADES



\*All Blades Are Made With Boron Steel!

PART #	DIAMETER	WAVE	APPLICATION	PRICE
M2515YW	14.9"	25 WAVE	CASE IH PLANTER/ WHITE	\$ 45.00
K15YWS	15"	13 WAVE	WHITE 5100/KINZE 4900	\$ 45.00
VT15DKDMW	15"	VORTEX	JD 5 HOLE / XP	\$ 40.00
VT15MLOL	15"	VORTEX	KZ 4900/ WHITE/ YETTER	\$ 40.00
845-9254	16"	13 WAVE 4 MM	YETTER / KINZE ( <b>Limited Supply!</b> )	\$ 34.95 SALE
K16Y34	16"	<b>13 WAVE 4.5MM HD</b>	YETTER / KINZE	\$ 40.00
M2516YW	16"	25 WAVE	YETTER/GP/KINZE	\$ 45.00
M2516KDMW	16" OEM	25 WAVE	ALL JD COULTERS	\$ 45.00
VT16DKDMWJDC	16"	VORTEX	JD 7000-1700	\$ 47.95
VT16MLOLC	16"	VORTEX	KINZE, YETTER, GP, WHITE	\$ 47.95
16177MLOLC	16"	SMOOTH	KINZE/YETTER/WHITE	\$ 38.00
16177DKDMWC	16"	SMOOTH	JD 5 HOLE/ OLD 7000	\$ 38.00
K16DKMW	16"	13 WAVE	JD 5 HOLE/ 7200 +	\$ 44.00
MF17177MLOL	17"	SMOOTH EDGE	YETTER	\$ 49.00
VT17MLOLC	17"	VORTEX	YETTER/ GREAT PLAINS	\$ 54.00
KW17MLOL	17"	13 WAVE	TYE, MARLISS, DMI, BLUE JET	\$ 44.00
KW17MLOL	17"	13 WAVE	YETTER, GP, WHITE, CIH DRILL	\$ 44.00
N17177YMR	17"	KNOTCHED	YETTER/BLUE JET	\$ 48.50
M25W17MLOL	17"	25 WAVE	BLUE JET, CIH, YETTER, GP	\$ 50.00
20177MLWR	20"	SMOOTH	DMI, BLUE JET	\$ 53.00
VT20MLOL	20"	VORTEX	YETTER/ ALL 4 BOLT PATTERN	\$ 78.95
MF20177MLOL	20"	FLUTED	4 Hole Multi-Pattern	\$ 49.95

\* SPECIAL PURCHASE

## VORTEX

### GREAT FOR PLANTING INTO COVER CROPS!

This blade is an excellent choice when being used on a planter ahead of a spiked closing wheel, or when additional stirring is needed. An excellent replacement for a "Turbo" type coulters.

## 25 WAVE

The 25 Wave coulters work a 5/8" wide strip in front of a trailing knife or nozzle application. This coulters is less likely to pull "Chunks" out like a 13 wave in wet soil.

## 13 WAVE

The 13 Wave is the original coulters used by many O.E.M. manufactures. In most seeding conditions we feel this coulters has poor penetration and seed depth.

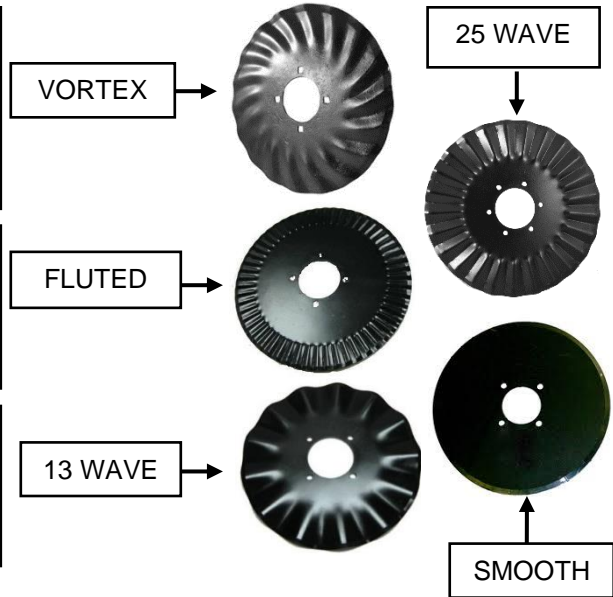

## COULTER BEARING SETS



PART #	TO FIT:	PRICE
KB-7-ME	JD 7200-1700 No-Till/Fertilizer Opener(SET)	\$ 32.95
GA5622	Kinze Double Arm Coulters (2 REQ. per Row)	\$ 10.00 Each
P2900K	Yetter No-Till/Fertilizer Coulters (SET)	\$ 22.95
5206KPP3-SP	Kinze 3000 Series-4 Bolt (1 per Row)	\$ 17.95
PK1002	DMI Hub Repair Kit	\$ 22.50

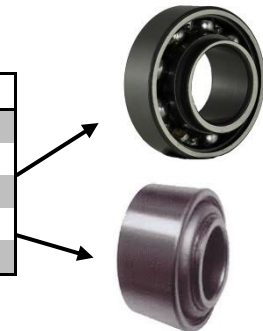

Please Call For Availability.  
PRICES SUBJECT TO CHANGE WITHOUT NOTICE!

## PLANTER / DRILL SEED DISC OPENERS



SIZE	THICKNESS	APPLICATION	BEARING TYPE	PRICE EA.
13.5"	4 MM 864-GP138	WHITE 5100 GREAT PLAINS	205 HD	\$ 34.95 SALE
13.5"	3.0MM	TYE	204	\$ 39.95 SALE
14"	3.5 MM	CIH 800-1200	LEADING 204	\$ 32.95 SALE
14"	3.5 MM	CIH 800-1200	TRAILING 204	\$ 32.95 SALE
14"	4.5 MM	CNH 1250>	NICHOLS HD LEADING	\$ 54.50 SALE
14"	4.5 MM	CNH 1250>	NICHOLS HD TRAILING	\$ 54.50 SALE
15"	3.5 MM	KZ 2000-3700	KOYO OEM 204	\$ 31.95 SALE
15"	3.5 MM	JD 7000-EARLY 1700	204	\$ 32.95 SALE
15"	3.5MM	JD 1750-95 XP OEM STYLE	204DR	\$ 30.00 SALE
15"	3.5 MM	JD 1750-95 XP	(NICHOLS) 205HD	\$ 44.50 SALE
15"	3.5 MM	CAST HUB / W/ CAP (OSMUDSON)		\$ 49.75 SALE
15"	4.0 MM	GREAT PLAINS	(5/8") 205	\$ 40.95 SALE
15"	4.5MM	CASE IH 2100+	205 DOUBLE	\$ 57.50 SALE
15 3/4"	4.0 MM	WHITE 9000/FENDT	205 DOUBLE	\$ 64.50 SALE

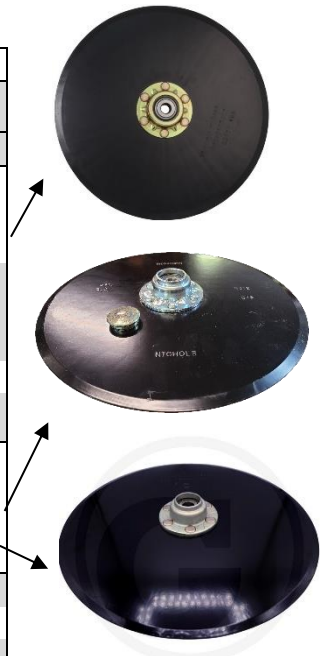

### PLANTER MAINTENANCE TIPS:

- \*Check your seed tube guards between the opener discs for proper operating width. A John Deere or Kinze planter should have a guard width measurement of no less than 1/2" at the bottom, and 3/4" across the top.
- \*15" seed openers should be replaced at an overall diameter of 14.5".
- \*Use an equal amount of shims on each side of the opener.

## ROW UNIT WEAR PART REBUILD KIT

Rebuild Your Existing Row Units With The Most Commonly Needed Parts!

MODEL	PART #	DESCRIPTION	PRICE PER ROW
JD 7000 / KZ 2000-2700	SKRURK-01	ROW UNIT KIT FOR EARLY JD AND KZ	\$ 319 SALE
JD 7200 - EARLY 1700	SKRURK-02	ROW UNIT KIT FOR 7200 - EARLY 1700	\$ 332 SALE
JD 1700 XP	SKRURK-03	ROW UNIT KIT FOR 1750XP-1790XP (NO CHAIN)	\$ 348 SALE
KZ 3000 SER.	SKRURK-04	ROW UNIT KIT FOR KZ 3000 SER.	\$ 353 SALE



### KIT CONSISTS OF:

- 2-SEED DISC OPENERS
- 1-TUBE GUARD W/ ROLL PINS
- 2-GAUGE WHEEL TIRES
- 2-GAUGE WHEEL BEARINGS
- 2-GAUGE WHEEL ARMS
- 1-BULLSEYE SEED TUBE
- 8-PARALELL ARM BUSHINGS
- 2-CLOSING FRAME BUSHINGS
- 1-25 WAVE COULTER BLADE
- 1-SEED METER DRIVE CHAIN



## C-IH PLANTER / DRILL PARTS



PART #	DESCRIPTION	PRICE EA.
SMA1277891	8" Planter Covering Disc W/ CAP	\$ 29.95
SCW8ZC	MARTIN 8" CUPPED RAZOR WHEELS	\$ 189 PER PAIR SALE
H29548	4.5" X 16" RID TIRE	\$ 42.95 SALE
H6512P	6.5" X 12" CLOSING TIRE W/ TREAD	\$ 69.50 SALE
SMA1264391	COVERING TENSION SPRING (800-1200)	\$ 8.95
SMA436740	UPPER PARALELL ARM 15 7/8" 800-1200	\$ 35.95 SALE
SMA436741	LOWERPARALELL ARM 15 7/8" 800-1200	\$ 113.00 SALE
SMA1254302	BUSHING LONG ARM W/ AIR BAG	\$ 4.95
SMA137512	BUSHING FOR SPLIT ROW ARMS	\$ 4.60
C84243	SEED SHOE	\$ 41.50
SMA436702	FIRMING POINT	\$ 15.95
013-313402	3" X 13" DRILL PRES WHEEL (51-5400)	\$ 76.00 SALE



# KINZE ROW UNIT PARTS

PART #	DESCRIPTION	PRICE EA.
P61577	SEED TUBE GUARD 2000-2700	\$ 8.95
KD0301	TOOL STEEL SEED TUBE GUARD 3000-3700	\$ 14.95
VA100150	VALION SEED TUBE GUARD 2000 SER.	\$ 53.95 SALE
VA100350	VALION 4000 SER. TUBE GUARD	\$ 43.95 SALE
P26443RB	SCRAPER RH	\$ 3.95
P26444LB	SCRAPER LH	\$ 3.95
P23789	PARALLEL ARM BUSHING (8 PER ROW)	\$ 1.10
730365	SEED BOX LID 3000 SER. +	\$ 25.00 SALE
P239/282	INNER /OUTER BUSHING SET FOR CLOSING FRAME(2 REQ)	\$ 5.95
P31217	CLOSING FRAME 2000-2300	\$ 42.95
KD8322	CLOSING FRAME 2500-4900	\$ 48.50
P254	T-HANDLE FOR CLOSING FRAME	\$ 10.50
P23116	CLOSING SPRING 2000-2300	\$ 14.75
P8460	CLOSING SPRING 2500-4900	\$ 8.95
P33879	CLOSING STOP 2000-2300	\$ 23.95
KD0268	CLOSING STOP 3000 SER. +	\$ 23.95
CW3150	CLOSING FRAME UPDATE KIT 2000-2300 (UPDATE FOR BOLT ON WHEELS)	\$ 70.00 SALE
GD8249	DOWN PRESSURE SPRING USA	\$ 9.95
SMA43899	CLOSING WHEEL 2000-2300	\$ 41.95 SALE
H33297B	CLOSING WHEEL 2500-4900 USA	\$ 48.95 SALE
SMA39968	CLOSING WHEEL 2500-4900 IMPORT	\$ 39.95 SALE
013-110SC	1 X12 CLOSING TIRE	\$ 8.95
WIB164069B	¼ CROSS HOLE GAUGE BEARING 2000-2300	\$ 10.95
5203KYY2	40MM GAUGE / CLOSING BEARING 2500-4900	\$ 9.50
11423-SH	WHITE GAUGE RIM	\$ 23.05 SALE
H204008	STD. GAUGE TIRE (USA)	\$ 37.50 SALE
864-9W	GAUGE WHEEL 2000-2300 (STEM)	\$ 105.50 SALE
864-98W	GAUGE WHEEL 2500-2700 (40MM)	\$ 105.50 SALE
864-142W	GAUGE WHEEL 3000-4900 (40MM)	\$ 109.95 SALE
H29548	REDUCED INNER DIA. TIRE USA	\$ 42.95 SALE
DM70	DEPTH-A-MATIC ROLLING DEPTH ADJUSTER 2000-2700	\$ 38.95 SALE
KD11001	3000-4900 PIVOT SHAFT FOR GAUGE ARMS	\$ 21.00 SALE
P41968N	GAUGE WHEEL ARM 2000-2300	\$ 34.95 SALE
AP6114N	GAUGE WHEEL ARM 2500-2700	\$ 33.95 SALE
12321676RH	HEAVY DUTY RH GAUGE ARM 3000-4900	\$ 34.95 SALE
12321677LH	HEAVY DUTY LH GAUGE ARM 3000-4900	\$ 34.95 SALE
1535KZKY	15" X 3.5 MM OPENER (KOYO BEARING)	\$ 31.95 SALE
488-1237104	OPENER GUARD	\$ 5.50
K16Y34	16" X 13 WAVE COULTER BLADE	\$ 40.00
5206KPP3	3000 SER. NO TILL COULTER BEARING	\$ 17.95
488-1238641	3000 SER. COULTER HUB W/ BEARING	\$ 42.95 SALE
N17K	2000 SER. KNOTCHED FERT. BLADE 17"	\$ 53.95
N17K3	3000 SER. KNOTCHED FERT. BLADE 17"	\$ 41.95
KD11422	3000 SER. UPER PULL PARALLEL ARM (2 REQ.)	\$ 24.50
F00-032	3000 SER. UPER PULL PARALLEL ARM W/ BEARINGS	\$ 85.00 SALE
C24693	3000 SER. LOWER PULL ARM ASSEMBLY	\$ 218.00 SALE

Please Call For Availability.  
PRICES SUBJECT TO CHANGE WITHOUT NOTICE!



### JD 7000 ROW UNIT PARTS



PART #	DESCRIPTION	PRICE EA.
P61577	SEED TUBE GUARD	\$ 8.95
VA100150	VALION SEED TUBE GUARD 7000-1700 EARLY	\$ 53.95 SALE
P26443RG	SCRAPER RH	\$ 3.95
P26444LG	SCRAPER LH	\$ 3.95
P23789	PARALLEL ARM BUSHING (8 PER ROW)	\$ 1.10
6000-523	CAM CLOSING FRAME BUSHING	\$ 6.95
P31217	CLOSING FRAME (ROLL PIN STYLE)	\$ 42.95
P23116	CLOSING SPRING	\$ 14.75
P33879	CLOSING STOP 7000	\$ 23.95
CW3150	CLOSING FRAME UPDATE KIT KINZE STYLE (UPDATE FOR BOLT ON WHEELS)	\$ 70.00 SALE
GA2068	DOWN PRESSURE SPRING	\$ 16.95
P43899	CLOSING WHEEL (STEM TYPE)	\$ 41.95 SALE
SMA39968	CLOSING WHEEL FOR (CW3150 FRAME) IMP	\$ 39.95 SALE
013-110SC	1 X12 CLOSING TIRE ONLY USA	\$ 8.95
885152	STEM CLOSING BEARING	\$ 7.75
205KRRB2	HEX BEARING FOR TRANSMISSION	\$ 12.50
WIB164069B	¼ CROSS HOLE GAUGE BEARING	\$ 9.95
32780Y-SH	YELLOW GAUGE RIM	\$ 19.95 SALE
H204008	STD. GAUGE TIRE (USA)	\$ 37.50 SALE
864-9Y	GAUGE WHEEL STEM BEARING	\$ 105.95 SALE
H29548	REDUCED INNER DIA. TIRE (USA)	\$ 42.95 SALE
DM70	DEPTH-A-MATIC ROLLING DEPTH ADJUSTER	\$ 38.95 SALE
APQ2550	GAUGE WHEEL ARM 2000-2300	\$ 34.95 SALE
SMA53860	15" X 3.5MM OPENER (JD HUB) W/ CAP	\$ 32.95 SALE
1535KZKY	15" X 3.5MM OPENER (KZ HUB) W/ CAP	\$ 31.95 SALE
M2516KDMW	16" X 25 WAVE COULTER BLADE	\$ 45.00
A9841	#41 X 98 LINK SEED DRIVE CHAIN	\$ 9.95
P205056	GROUND DRIVE CHAIN # 2050	\$ 22.95
F25447	METER DRIVE DISCONNECT HANDLE	\$ 4.50
123212	SEED DRIVE IDLER UPDATE KIT	\$ 10.95
864-HD27458	13.5" FERT. BLADE W/ HUB	\$ 44.95 SALE
P23113	LIQUID FERTILIZER TUBE FOR DOUBLE DISC	\$ 9.00
AP430000	KNOTCHED MARKER ASSEMBLY	\$ 89.95



### JD 7200 ROW UNIT PARTS



PART #	DESCRIPTION	PRICE EA.
P61577	SEED TUBE GUARD	\$ 8.95
P37221K	ROTARY SCRAPER KIT	\$ 21.95
P48515	9/16" UPPER ARM BUSHING (6 PER ROW)	\$ 2.10
P49465	LOWER REAR ARM BUSHING 21/32" (2 PER ROW)	\$ 2.10
P48430	RH CLOSING FRAME BUSHING	\$ 4.95
P48290	LH CLOSING FRAME BUSHING	\$ 3.25
P53118	CLOSING FRAME STOP	\$ 29.50
P37552	CLOSING FRAME W/ AXLE MOUNT	\$ 56.95
P43898	CLOSING WHEEL ASSEMBLY	\$ 42.95
APQ2550	GAUGE WHEEL ARM KIT 1" SPINDLE (OLDER 7200)	\$ 34.95 SALE
P54179	GAUGE WHEEL ARM KIT 16MM BOLT (LATE 7200 /1700 EARLY)	\$ 38.95 SALE
P74643-K	CLOSING FRAME SPRING	\$ 9.95
P76223-K	UPPER SHORT PARALLEL ARM	\$ 20.95 SALE
P52092	LOWER CAST SHORT PARALLEL ARM	\$ 138.95 SALE
864-99Y	GAUGE WHEEL W/ GROOVE STEM BEARING	\$ 106.95 SALE
DM72	DEPTH-A-MATIC ROCKER ASSEMBLY	\$ 49.95 SALE
B73917	18" KNOTCHED MARKER BLADE	\$ 48.95

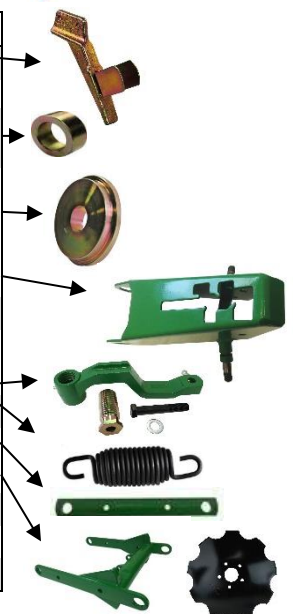

\*PRICES SUBJECT TO CHANGE WITHOUT NOTICE!

## PLANTER / DRILL GAUGE WHEEL ASSEMBLIES



MODEL #	PART#	DESCRIPTION	PRICE EA.
JD 7000	864-9Y	YELLOW STEEL RIMS W/ JD STYLE TIRE AND ¼ CROSS BEARING	\$ 105.95 SALE
KZ 2000-2300	864-9W	WHITE STEEL RIMS W/ KZ STYLE TIRE AND ¼ CROSS BEARING	\$ 105.50 SALE
KZ 2500-2700	864-98W	WHITE STEEL RIMS W/ KZ STYLE TIRE AND 40MM BEARING	\$ 105.50 SALE
KZ 3000+	864-142W	METAL RIM WHITE COVER W/ KZ STYLE TIRE 40MM BEARING	\$ 109.95 SALE
JD 750	864-98Y	YELLOW STEEL RIMS W/ JD STYLE TIRE AND 40MM. BEARING	\$ 106.95 SALE
JD 750	864-9CY	YELLOW STEEL RIMS W/ CIH STYLE TIRE AND 40MM. BEARING	\$ 105.50 SALE
JD 1700	013-70657	METAL RIM / POLY OUTER RIM 3" TIRE 40MM BEARING <b>NON XP</b>	\$ 95.95 SALE
JD 1700	864-142B	METAL RIM BLACK COVER W/ JD STYLE TIRE 40MM BEARING	\$ 106.95 SALE
JD 1700 XP	A467704-86	METAL RIM BLACK / NYLON RIM W/ JD <b>XP STYLE TIRE</b> 40MM BEARING	\$ 96.50 SALE
JD 7200	864-99Y	YELLOW STEEL RIMS W/ JD STYLE TIRE AND GROOVE STEM BEARING	\$ 106.95 SALE
JD 7200 LATE 1700 EARLY	864-132B	METAL RIM BLACK COVER W/ JD STYLE TIRE GROOVE STEM BEARING	\$ 113.95 SALE
CASE IH 900	864-144B	BLACK STEEL RIMS W/ CIH STYLE TIRE AND GROOVE STEM BEARING	\$ 127.00 SALE
CASE IH 1200	864-146B	METAL RIM BLACK COVER W/ CIH STYLE TIRE 40MM BEARING	\$ 108.95 SALE



### GAUGE WHEEL COMPONENTS

PART #	DESCRIPTION	PRICE
32780Y-SH	YELLOW STEEL RIM FOR GAUGE WHEELS	\$ 19.95 SALE
11423-SH	WHITE STEEL RIM FOR GAUGE WHEELS	\$ 23.05 SALE
66621-SH	BLACK STEEL RIM FOR GAUGE WHEELS	\$ 20.95 SALE
51634	5/16" X 3/4" BOLT PACK (100 PC.)	\$ 10.50
864-416CV01	BLACK POLY OUTER COVER	\$ 8.95 SALE
864-416CV03	WHITE POLY OUTER COVER	\$ 17.95 SALE
H204008	STANDARD GAUGE TIRE (USA)	\$ 37.50 SALE
H29548	RID/ CIH TYPE GAUGE TIRE (USA)	\$ 42.95 SALE
H32020	JD 1700 XP GAUGE TIRE USA)	\$ 37.50 SALE
WIB164069B	¼ CROSS HOLE BEARING EARLY JD/CIH/ KZ	\$ 9.95
P38106B	GROOVE STEM BEARING JD7200/CIH 900+	\$ 12.95
5203KYY2IMP	40MM BEARING (IMPORT) JD 1700/ KINZE 2500+	\$ 9.50
A450	ARM STOP FOR USE WITH NON XP TIRE ON XP ROW UNIT	\$ 15.95



## CARLISLE SPOKED GAUGE WHEELS

Traditional closed gauge wheels tend to plug when planting conditions are less than ideal. The Spoke Planter Gauge Wheel from Carlisle helps you avoid that frustrating downtime. The open-wheel design allows soil and residue to flow through the spokes, so you spend more time planting and less time cleaning out gauge wheels.



PART #	DESCRIPTION	PRICE EA.
CF-GW316SK40	3X16" W/ 40MM BEARING	\$ 169 SALE
CF-GW416SK40	4.5X16" W/ 40MM BEARING	\$ 189 SALE



Please Call For Availability.  
PRICES SUBJECT TO CHANGE WITHOUT NOTICE!

## JD "XP" ROW UNIT PARTS

	PART #	DESCRIPTION	PRICE EA
	F80203	SEED TUBE GUARD XP	\$ 12.95
	F97107	SEED TUBE GUARD XP (ME5)	\$ 15.95
	753070	PRECISION PLANTING DURAWEAR XP GUARD HD	\$ 30.00 SALE
	AA81315-AI	TUBE GUARD TO FIT JD EXACT EMERGE	\$ 69.95
	P98182R	SCRAPER RH	\$ 7.25
	P98183L	SCRAPER LH	\$ 7.25
	P98180KIT	SCRAPER KIT W/ SPRING	\$ 16.95
	P37221-K	ROTARY SCRAPER KIT	\$ 21.95
	P37221	ROTARY SCRAPER WHEEL	\$ 5.50
	P48515	9/16" UPPER ARM BUSHING (6 PER ROW)	\$ 2.15
	P49465	21/32" LOWER REAR ARM BUSHING (1 PER ROW)	\$ 2.15
	P78121	13/16" LOWER ARM BUSHING (1 PER ROW)	\$ 3.95
	BK1645-10.9	M16 X 45 BOLT W/ LOCKNUT (6 PER ROW)	\$ 2.45
	BK1660-10.9	M16 X 60 BOLT W/ LOCKNUT (2 PER ROW)	\$ 2.75
	PR3142RK	RK CLOSING FRAME BEARING KIT (WELD IN)	\$ 38.95 SALE
	P55888	CLOSING FRAME BUSHING (2 REQ)	\$ 5.50
	P64237	T-HANDLE FOR CLOSING FRAME	\$ 11.95
	P86763	CAST CLOSING FRAME	\$ 56.95
	P74643-K	CLOSING SPRING	\$ 9.95
	P55889	CLOSING WHEEL STOP	\$ 33.50
	CW90B-2KIT	CLOSING FRAME UPDATE KIT W/SPRING AND STOP	\$ 195.00 SALE
	CW90 KIT	<b>CLOSING FRAME KIT OEM STYLE</b>	\$ 140.00 SALE
	B72361	KNOTCHED MARKER BLADE	\$ 41.95
	5203KYY2IMP	40 MM. GAUGE / CLOSING WHEEL BEARING	\$ 9.50
	013-110SC	RUBBER CLOSING TIRE ONLY	\$ 8.95
	H33297B	RUBBER CLOSING WHEEL ASSEMBLY USA	\$ 48.95 SALE
	P772K	GAUGE WHEEL WALKING DEPTH CONTROL STOP	\$ 35.95 SALE
	P609	WALKING DEPTH ROCKER	\$ 13.95
	P670	WALKING DEPTH ROCKER BOLT	\$ 3.95
	<b>C90344</b>	DEPTH ADJUSTER HANDLE KIT W/ SNAP RING	\$ 26.95
	87880-SH	BLACK STEEL INNER RIM FOR GAUGE WHEELS	\$ 20.95 SALE
	C56565	POLY OUTER RIM HALF	\$ 21.95
	PRM-C	POLY OUTER RIM COVER CONVERSION KIT (416CV01)	\$ 33.50
	<b>H32020</b>	XP GAUGE WHEEL TIRE O.E.M. REPLACEMENT (CARLISLE OEM USA)	\$ 70.00 SALE
	A467704-86	METAL RIM BLACK POLY OUTER <b>XP STYLE TIRE</b> 40MM BEARING (USA)	\$ 96.50 SALE
	P79648	ORIGINAL "XP" GAUGE WHEEL ARM	\$ 32.95 SALE
	AP92817	NEW STYLE "XP" GAUGE ARM SN 76101> (with bolts)	\$ 37.95 SALE
	<b>EA646GWA</b>	<b>XP GAUGE ARM WITH (2) BEARINGS</b>	\$ 75.00 SALE
	125012	UNIVERSAL DRY SEED FIRMER	34.00 SALE
	115011	UNIVERSAL LIQUID SEED FIRMER (NON EXACT EMERGE)	34.00 SALE

Please Call For Availability.  
PRICES SUBJECT TO CHANGE WITHOUT NOTICE!

# JD "XP" ROW UNIT PARTS

PART #	SIZE	DESCRIPTION	PRICE EA
P76223-K	16"	UPPER SHORT PARALLEL ARM (2 PER ROW)	\$ 20.95 SALE
P52092	16"	LOWER SHORT PARALLEL ARM CASTING (1 PER ROW)	\$ 138.95 SALE
KB-P1700S	16"	SHORT ARM KIT UPPER AND LOWER W/ BUSH (1 KIT PER ROW)	\$ 229.00 SALE
P61571	23"	UPPER LONG PARALLEL ARM (2 PER ROW)	\$ 34.95 SALE
P65304	23"	LOWER LONG PARALLEL ARM CASTING (1 PER ROW)	\$ 235.00 SALE
KB-1700L	23"	LONG ARM KIT UPPER AND LOWER W/ BUSH (1 KIT PER ROW)	\$ 340.00 SALE
<b>F00-028U</b>	<b>16"</b>	<b>UPPER SHORT PARALLEL ARM W/ BEARINGS (2 PER ROW)</b>	<b>\$ 85.00 SALE</b>
<b>FOO-028L</b>	<b>16"</b>	<b>LOWER SHORT ARM WITH BEARINGS</b>	<b>\$ 225.00 SALE</b>
<b>EA16PAK</b>	<b>16"</b>	<b>LOWER SHORT ARM KIT WITH BEARINGS</b>	<b>\$ 385.00 SALE</b>
<b>F00-030</b>	<b>23"</b>	<b>UPPER LONG PARALLEL ARM W/ BEARING (2 PER ROW)</b>	<b>\$ 89.00 SALE</b>
<b>EA23PAK</b>	<b>23"</b>	<b>LONG LOWER ARM KIT WITH BEARINGS</b>	<b>\$ 420.00 SALE</b>
C52156	A52156	RH CAST SHOE FOR SN # <720100 (12.5" H)	\$ 43.95
C52157	A52157	LH CAST SHOE FOR SN # <72100 (12.5" H)	\$ 43.95
C82832	A82832	RH CAST SHOE FOR SN # 720101> (8-7/8" H)	\$ 49.95
C82833	A82833	LH CAST SHOE FOR SN # 720101> (8-7/8" H)	\$ 49.95
K16197D	16X3/16"	7200- EARLY 1700 BLADE W/ 2.5" HOLE	\$ 37.95 SALE
K16197D17	16X3/16"	LATE 1700 BLADE W/ 3-1/8" HOLE	\$ 37.95 SALE
HRPS-WP6	-----	HIGH RATE SENSOR 6" TAIL	\$ 96.95
P67780	-----	CLEAR SEED TUBE XP SERIES	\$ 9.95 SALE
STB-1	22" L	SEED TUBE BRUSH	\$ 10.95
C55983	ARM	FERT GAUGE ARM RH (SN<720100)	\$ 65.95
C55984	ARM	FERT GAUGE ARM LH (SN<720100)	\$ 65.95
CN48724	SPINDLE	SPINDLE FOR JD SINGLE DISC FERT. OPENER	\$ 30.95
P137235	NUT	JAM NUT W/ SCREWS FOR OPENER SPINDLE	\$ 5.75
KB7ME-2	BEARING KIT	FERTILIZER OPENER	\$ 29.95
65248XP	15" X 3.5MM	STANDARD XP OPENERS	\$ 30.00 SALE
1535XP205	15" X 3.5MM.	HD SEED OPENER W/ 205 BEARING & CAP (NICHOLS)	\$ 44.50 SALE
<b>WJDXP-C-OM</b>	<b>15" X 3.5MM</b>	<b>HD CAST HUB SEED OPENER W/ CAP (OSMUDSON)</b>	<b>\$ 49.75 SALE</b>
KB7ME	-----	BEARING SET No-Till COULTER	\$ 34.95
VT16DKDMWJDC	16"	VORTEX NO TILL COULTER	\$ 47.95
M2516KDMW	16" OEM	25 WAVE COULTER	\$ 45.00
A10341	103 LINK	STD ARM FINGER METER CHAIN	\$ 15.75
A11341	112 LINK	STD ARM VAC METER CHAIN	\$ 14.95
A14041	140 LINK	LONG ARM VAC METER CHAIN	\$ 17.95
P79254	16MM	16MM LEFT HAND OPENER STUD	\$ 12.95
P78210	16MM	16MM RIGHT HAND OPENER STUD	\$ 12.95
JN16LH	16MM	LEFT HAND OPENER NUT	\$ 1.95
JN16RH	16MM	RIGHT HAND OPENER NUT	\$ 1.95
73942	-----	ROW UNIT AIR BAG	\$ 85.00
C48393	-----	METER FLEX DRIVE COUPLER	\$ 27.95
CAST-XP	12.5"	CAST CLOSING WHEEL ASSEMBLY	\$ 72.95
P48879	-----	FRONT OPENER GUARD	\$ 10.95
C62767	-----	ROW UNIT OPENER SHANK	\$ 230.00
C83257	-----	ROW UNIT HEAD FRAME	\$ 186.00
RU17XP	-----	ROW UNIT ASSEMBLY W/ ARMS, WHEELS, OPENERS AND CLOSING FRAME	\$ 1245 SALE

Please Call For Availability.  
 PRICES SUBJECT TO CHANGE WITHOUT NOTICE!

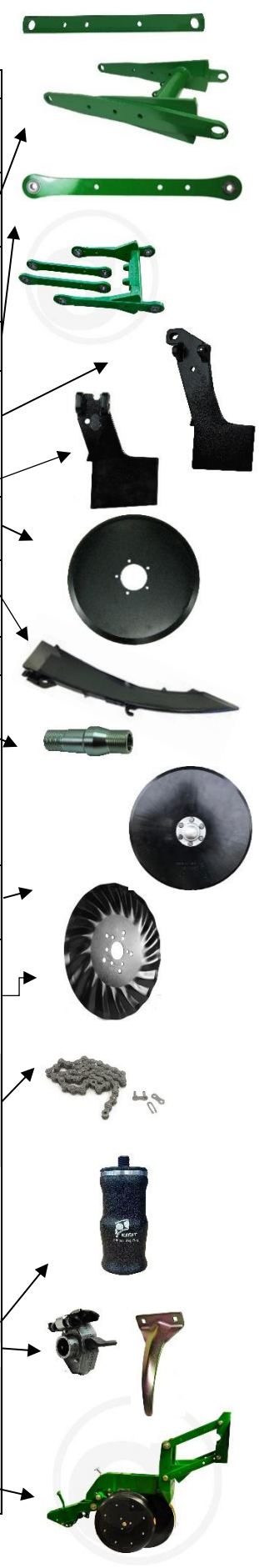
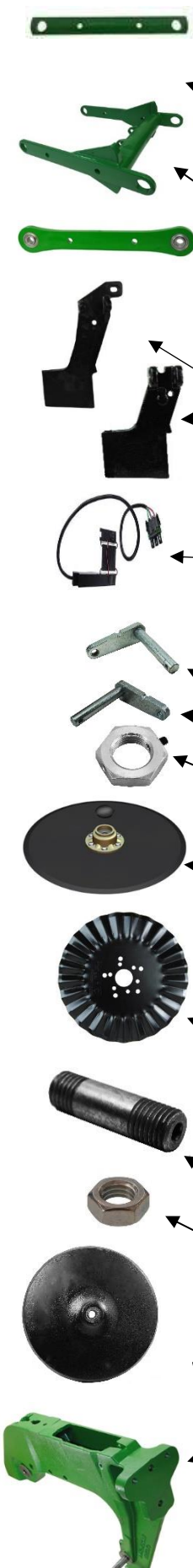

## WHITE 6-9000 PLANTER PARTS



PART #	DESCRIPTION	PRICE EA.
P855161	CLOSING FRAME TAIL 8000 SER.	\$ 84.00
AP78414	LH GUAGE WHEEL ARM 8000 SER.	\$ 62.00
AP78415	RH GUAGE WHEEL ARM 8000 SER.	\$ 62.00
P858761	LH PIVOT STRAP	\$ 14.95
P858762	RH PIVOT STRAP	\$ 14.95
CN858768	PIVOT SHAFT	\$ 22.00
P23789	PARALLEL ARM BUSHINGS	\$ 2.30
P856594	CLOSING FRAME SPRING 6000/8000	\$ 7.95
864-GP138	13.5" HD OPENER (5100 SER.)	\$ 34.95 SALE
1535204	15" SEED OPENER W/ CAP (6-8000)	\$ 32.95 SALE
15.754205	15 3/4" SEED OPENER W/ CAP (9000 SER)	\$ 64.50 SALE

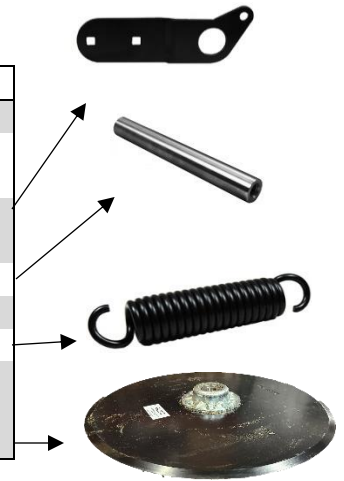

PLANTER ROW UNIT DRIVE CHAINS					
PART #	MODEL	METER TYPE	SIZE	LINKS	PRICE
A12041	CNH 1200	VAC	#41	120	\$ 13.95
A9841	JD 7000	FINGER	#41	98	\$ 10.95
A10241	JD ME2 (<1992)	FINGER/ HERB	#41	102	\$ 11.25
A10441	JD ME2-XP	SHORT ARM FINGER	#41	104	\$ 11.25
A10541	JD ME2 (<1992)	INSECTICIDE	#41	105	\$ 12.50
A11041	JD 7000	INSECTICIDE	#41	110	\$ 14.50
A11241	JD ME2-XP	SHORT ARM VAC	#41	112	\$ 17.95
A11341	JD ME2-XP	INSECTICIDE	#41	113	\$ 15.95
A13241	JD ME2-XP	LONG ARM FINGER	#41	132	\$ 15.95
A14041	JD ME2-XP	LONG ARM VAC	#41	140	\$ 15.95
P204038	JD 7000	SEED TRANSMISION	#2040	38	\$ 9.95
P204044	JD 7000	TRANSMISION	#2040	44	\$ 13.95
A532050	4N, 4W, 6N	WHEEL DRIVE	#2050	53	\$ 17.95
A542050	7200 4N-6N	WHEEL DRIVE	#2050	54	\$ 18.95
P205056	6N, 8W, 12N	WHEEL DRIVE	#2050	56	\$ 22.95
A9741	KZ 2300-2600	PUSHER	#41	97	\$ 13.95
A9841	KZ 2000+	(PULL) FINGER	#41	98	\$ 10.95
A10041	KZ EDGE VAC	PUSHER	#41	100	\$ 14.95
A10841	KZ EDGE VAC	PULL UNIT	#41	108	\$ 16.50
A12441	KZ EDGE VAC	PULL SET BACK 4"	#41	124	\$ 17.95
A11041	WHITE	6000 SER.	#41	110	\$ 14.50
A12041	WHITE	5000 SER.	#41	120	\$ 16.95
A13841	WHITE	8000 SET BACK	#41	138	\$ 15.95
1231212	7000/ KZ	PULL CHAIN IDLER KIT	#41	----	\$ 10.95
70300	KZ PUSHER	CHAIN IDLER KIT	#41	----	\$ 12.95

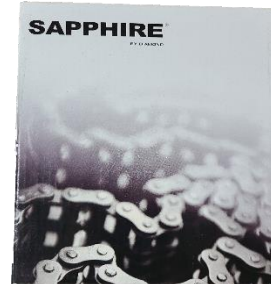

### BULK VAC/ SEED DELIVERY HOSE



CB1121	1" X 100'	KINZE SEED DELIVERY HOSE	\$ 189 SALE
PP731073	1 1/4" X 100'	JD/ PRECISION SEED DELIVERY HOSE	\$ 150 SALE
CB112212	2 1/2"	JD AIR SEEDER SEED HOSE	\$ 3.20 PER FT.
PP730175	1 1/4" X 50'	JD / PRECISION VAC HOSE	\$ 150 SALE



Please Call For Availability.  
PRICES SUBJECT TO CHANGE WITHOUT NOTICE!