



ABOUT THE HOME

- Open floor plan
- Modern hill country
- Custom swimming pool
- Spacious outdoor living
- Upgraded fireplaces
- Interior brick work
- Cathedral beam work
- Multiple ceiling treatments
- Extra lighting features
- Detailed closet designs
- Upgraded cabinet work/vent hood design
- Multiple upgraded hard surfaces
- Site work gives you spacious view in the back yard
- Custom shower/tile work

SUPPORTED BY

A/C Contractors
 Aspen Electronics
 Ben Salter Construction
 Cooks Lighting & Flooring
 Designer Accents
 Eastman Credit Union
 Elliot Electric
 Hitt Properties
 JMH Electric

Johnny's Carpet One
 Floor and Home
 Longview Glass
 Mccoy's Building Supply
 National Wholesale Supply
 Overhead Door Company
 Phillips Flooring Center
 Red River Brick &
 Building Materials

Sanchez Veliz
 Insulation Services
 Satterwhite Log Homes
 Sherwin Williams
 The Gallery of Lights
 The Stone Link
 Unlimited Cabinets and Doo
 Wilson Window Coverings

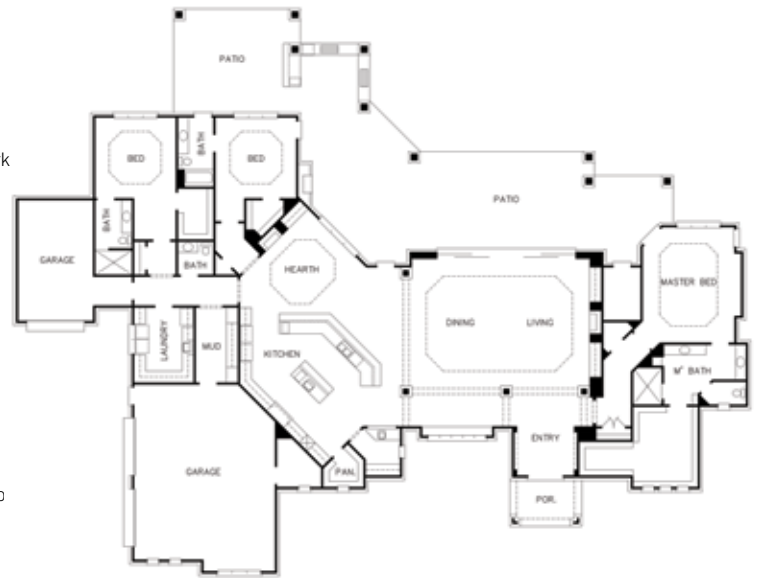

BED	BATH	GARAGE	SQ. FT.	SCHOOLS
3	3.5	5	4,283	Hallsville ISD

MEET THE BUILDER



HITT PROPERTIES
Jimmy & Heidi Hitt



903-738-8261
 jimmyhitt60@gmail.com
 www.hittproperties.com

DIRECTIONS

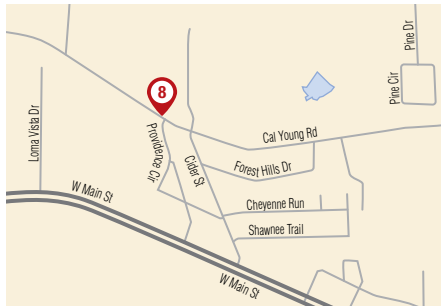

From Hwy 80/E. Marshall Ave. & Hwy 259/ Eastman Rd. in Longview: Head east on Hwy 80/E. Marshall Ave. for 5.9 miles. Turn left onto Mt. Pleasant Rd. for 0.2 miles. Turn right onto Cal Young Rd. for 1 mile. The home is on the left.

ACREAGE • 1087 CAL YOUNG, HALLSVILLE